

HOPKINS COUNTY FAIR

JULY 31 - AUGUST 8, 2026

**THE
TRADITION
CONTINUES**



OFFICIAL PROGRAM / ENTRY SCHEDULE

WWW.HOPKINSCOUNTYFAIR.COM



ROOFING

MILLER CONSTRUCTION

270-399-9132

FREE INSPECTIONS

HOPKINS COUNTY FAIR

OFFICERS

Tom Gulley
President

Byron Pruitt
Vice President

Brian Jones
Vice President

Ray Cartwright
Vice President

Alan Lutz
Treasurer

Karen Lutz
Fair Secretary

BOARD OF DIRECTORS

Kellie Arnold
Ray Austin

Megan Blue
Debbie Boyd

Alyssa Browning

Ray Cartwright
Kathy Carver

Amy Jones Cline
Keith Curneal

Cathy Dickerson

Billy Duvall
Todd Duvall

Harold Fowler
Logan Gulley

Tom Gulley

Kim Harrison

Debbie Johnson

Brian Jones
Allen LeGrand

Chris Lewis

Alan Lutz

Karen Lutz

Andy Peyton

Jason Pollard

Byron Pruitt

Darwin Rideout

John Rudd

Carrie Seymore

Amy Thomison

Andy Thomison

Jack Wagoner

Mark Winstead

HONORARY BOARD OF DIRECTORS

Sissy Lutz

Allen Seibert

GiGi Smith

James Lee Stevens

Eva Tucker

PAST PRESIDENT

***Ashby Corum**

***Elmer Boggess**

***John H. Gray**

***A. H. Wiley**

***Harold Seibert**

***Willis Parker**

James L. Stevens

Allen Seibert

***Bruce Jones**

RULES & REGULATIONS

The Hopkins County Fair, Inc. is planned and conducted to rules and regulations of the Kentucky Department of Agriculture for use of State Funds.

1. Admission Policy - Mon - Sat \$15.00 Sun \$10.00 daily admission price includes fair admission, all events and unlimited rides on the Midway. Individual entry fees, games and food are extra. The admission charge applies to all patrons entering the fair. No discounts will be given to those choosing not to ride the carnival rides. All ride heights are posted on ticket booths. No re-entry.
2. No admission refunds and/or rain checks for any event/show or rides.
3. The Fair Board reserves the right to close any exhibit operated without recourse, if it be deemed to be set up or operated in any way not in the best interest of the fair.
4. Premium will be paid by the Hopkins County Fair as early as possible after the awards in the various departments have been made and checked.
5. Any premium check not cashed by the last day of November 2026 will be forfeited to the Hopkins County Fair.
6. Each concessionaire will confine him/herself to the space assigned to him/her. Failure to do so will subject to dismissal from the fair.
7. The Fair assistants will exercise every reasonable precaution to safeguard the public, exhibitors, employees and exhibits, but positively will not be liable for death, loss, theft, damages, or injuries to person, animal and articles.
8. Neither the Hopkins County Fair Board, web page designer, or catalog publishers are to be held in any way liable for any misprints or errors.
9. Events, times, prize money, or rules may be changed as deemed necessary by the Hopkins County Fair Board.
10. No exhibitor may draw more than two monies in any one class. Adult classes open to all exhibitors.
11. Registration papers will not be required for 4-H and F.F.A. classes.
12. The management will not be responsible for accidents.
13. The judges' decisions will be final. The judge may refuse to consider any animal which in his opinion is being shown out of class.
14. The exhibitor is to provide necessary care for animals during the entire time they remain on the grounds.
15. All goats must have been born after August 15th.
16. Unruly beef bulls are subject to being excused from the show ring.
17. If in the opinion of the health inspector (from the state Veterinarian's office) an animal shows symptoms of communicable disease (pink eye, ringworm, etc.) the animal will not be allowed to be unloaded from the truck or other vehicle and participate in the show.
18. General Farm and Garden displays shall be vegetables produced by the exhibitor and be arranged for display in container (tray or basket) when brought in by the exhibitor. Display will be judged on variety, attractiveness, originality and quality of products.
19. Poultry and rabbits will be displayed in show coops furnished by the management.
20. For rules affecting entry and release times on livestock, see each department.
21. No dogs allowed on Fairgrounds, service dogs exempt from this rule with proper ID.
22. Entries made in 4-H and F.F.A. classes must have been produced in conjunction with an approved project sponsored by these organizations. "open" classes are open to all exhibitors unless otherwise specified.
23. The manager or superintendent of any department shall have the authority without liability or recourse to the Hopkins County Fair Board, to bar any exhibitor or his/her representatives, in the event of a discourteous act to a Judge or an official of the Fair, and he/she shall have power to disqualify the entry of said exhibitor. In the event of such disqualifications, the exhibitor forfeits any prize money won.
24. Kentucky State Fair guidelines will govern all youth open and youth livestock shows.
25. All beauty pageants conducted according to the KAFHS rules and regulations.

MAP OF THE HOPKINS COUNTY FAIR

1. CONVENTION CENTER
2. EXHIBIT HALL
3. FIRST UNITED BANK COMMUNITY EXPO CENTER
4. POULTRY BARN
5. FIRST AID STATION
6. FAIR OFFICE
7. CATTLE BARN
8. SHOW RING
9. HOG BARN
10. SCOTTY'S PAVILION
11. FOOD COURT
12. PARKING

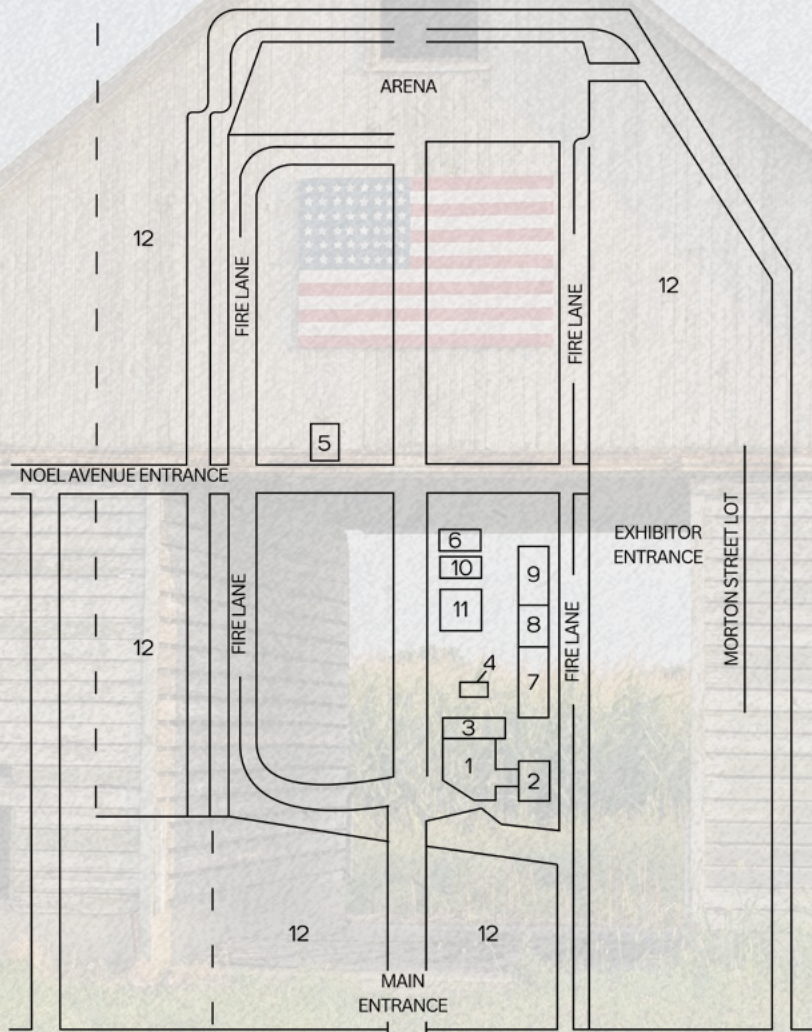

\$1,000 GIVEAWAY

Sponsored by the Hopkins County Fair

TICKETS

Tickets are FREE! Tickets will be handed out at the stamp booths.

Didn't get them when you came in? Don't worry! We will be passing them out right before the drawing by Scotty's Pavilion.

WHEN & WHERE

Join us at Scotty's Pavilion located on the Midway!

- Saturday, August 1, 10:00 p.m.
- Saturday, August 8, 10:00 p.m.

TICKETS

- Must be 18 years of age to enter
 - Must be present to win
- Tickets stay in the barrel July 31 - August 8, 2026
- No Hopkins County Fair Board member can win or enter



2025 KENTUCKY ASSOCIATION OF FAIRS AND HORSE SHOWS AWARDS



LEFT TO RIGHT: MARK WINSTEAD, BRIAN JONES, JACK WAGONER, TOM GULLEY, RAY CARTWRIGHT

The Hopkins County Fair was honored to receive four awards at the 2025 Kentucky Association of Fairs and Horse Shows:

- Overall Runner-Up Most Progressive Fair
- Zone 1 Division B Most Progressive Fair
- Best Website
- Best Catalog

These recognitions mean a great deal to us and reflect the hard work of our board members, volunteers, and the continued support of our community. We are thankful for everyone who attends, participates, and helps the fair grow each year.

The Most Progressive Fair award is given to the county fair that shows the most growth from the previous year, and we are proud to see that progress recognized.

We'd like to extend a special thank you to Zack Boarman of Zack's PC Repair for designing and updating our website, and to board member Jack Wagoner for his work on this year's award-winning catalog.

We appreciate the support that makes all of this possible and look forward to another great year at the fair.

SCHEDULE OF EVENTS

The Tradition Continues at the 2026 Hopkins County Fair

FRIDAY, JULY 31

Weekend Full of Fun Starts Here

4:00 p.m. - Rabbit Show entry till 6:00 p.m.

5:30 p.m. - Gates Open

5:30 p.m. - Midway opens with rides provided by Miller Spectacular Shows

5:30 - 11:00 p.m. - Helicopter Rides (not included in admission)

6:00 p.m. - Rabbit Show judging

7:00 p.m. - Ms. and Mrs. Hopkins County Fair Pageant

7:00 p.m. - Mid South Truck & Tractor Pulling in the Arena
Local Street pull to follow

8:00 p.m. - Instant Zeal Band at Scotty's Pavilion

11:00 p.m. - Midway closes



SATURDAY, AUGUST 1

Weekend Full of Fun Starts Here

4:00 p.m. - Poultry Show entry till 6:00 p.m.

4:00 p.m. - Market Goat and Lamb Show entry till 6:00 p.m.

5:30 p.m. - Gates Open

5:30 p.m. - Midway opens with rides provided by Miller Spectacular Shows

5:30 - 11:00 p.m. - Helicopter Rides (not included in admission)

6:00 p.m. - Poultry Show judging

7:00 p.m. - Miss Hopkins County Fair Pageant

7:00 p.m. - Mid South Truck & Tractor Pulling in the Arena
Ohio Valley Truck & Tractor pull to follow

8:00 p.m. - \$1,000 Prize Money Drawing at Scotty's Pavilion

11:00 p.m. - Midway closes



SUNDAY, AUGUST 2

Sunday Fun Day



1:00 p.m - Gates Open

1:00 p.m - Midway opens with rides provided by Miller Spectacular Shows

1:00 - 5:00 p.m. - Helicopter Rides (not included in admission)

5:00 p.m - Rides close

5:00 p.m - Food vendors open from 5:00 p.m. - 8:00 p.m. for community without admission

6:00 p.m - FREE Gospel Concert in the First United Bank Community Expo Center

MONDAY, AUGUST 3

Family Fun Day



9:00 a.m - 6:00 p.m.

- 4-H Home Economics & Agriculture and FFA division begins accepting entries
- Fruits & Vegetables and Adult Farm Crops entries to be entered
- Home & Garden Dept. begins accepting all entries except Baked Goods and Florals

5:30 p.m - Gates Open

5:30 p.m - Midway opens with rides provided by Miller Spectacular Shows

6:00 p.m - Mark Comley Magic Show on the Midway until 10:00 p.m.

7:00 p.m - Miss Pre-Teen Hopkins County Fair Pageant

7:00 p.m - Hot Air Balloon Rides (Located outside the Morton Ave. Gate)

7:00 p.m - Go-Kart racing in the Arena

7:00 p.m - Karaoke Contest at Scotty's Pavillion

10:30 p.m - Midway closes

TUESDAY, AUGUST 4

Family Fun Day



9:00 a.m - Noon

- Home and Garden Department begins accepting Baked Goods and Floral

9:00 a.m - Judging of 4-H Home Economics & Agriculture, FFA division, Fruits & Vegetables, Adult Farm Crops, and Home & Garden Dept. except Baked Goods and Floral

11:00 a.m - FFA Seed Identification

4:00 p.m - Swine Show entry till 6:00 p.m.

5:30 p.m - Gates Open

5:30 p.m - Midway opens with rides provided by Miller Spectacular Shows

6:00 p.m - Mark Comley Magic Show on the Midway until 10:00 p.m.

6:30 p.m - Swine Show

7:00 p.m - Miss Teen Hopkins County Fair Pageant

7:00 p.m - Antique Tractor Pull in the Arena

7:00 p.m - Hot Air Balloon Rides (Located outside the Mortons Ave. Gate)

7:00 p.m - Karaoke Contest at Scotty's Pavilion

10:30 p.m - Midway closes

WEDNESDAY, AUGUST 5

Family Fun Day



5:30 p.m - Gates Open

5:30 p.m - Midway opens with rides provided by Miller Spectacular Shows

6:00 p.m - Mark Comley Magic Show on the Midway until 10:00 p.m.

7:00 p.m - Motocross & ATV Races in the Arena

7:00 p.m - Karaoke Contest at Scotty's Pavilion

10:30 p.m - Midway closes

THURSDAY, AUGUST 6

Weekend Full of Fun Starts Here

4:00 p.m - Cattle Show entry till 6:00 p.m.

5:30 p.m - Gates Open

5:30 p.m - Midway opens with rides provided by Miller Spectacular Shows

5:30 - 11:00 p.m - Helicopter Rides (not included in admission)

6:00 p.m - Cattle Show judging

6:00 p.m - Mark Comley Magic Show on the Midway until 10:00 p.m.

7:00 p.m - Talent Show in the Midway Building

7:00 p.m - Figure 8 Races in the Arena

7:00 p.m - Karaoke Contest at Scotty's Pavilion

10:30 p.m - Midway closes



FRIDAY, AUGUST 7

Weekend of Fun Starts Here

10:00 a.m - Pet Show in the Midway Building

5:30 p.m - Gates Open

5:30 p.m - Midway opens with rides provided by Miller Spectacular Shows

5:30 - 11:00 p.m - Helicopter Rides (not included in admission)

6:00 p.m - Mark Comley Magic Show on the Midway until 10:00 p.m.

7:00 p.m - Little Miss and Mister Hopkins County Fair Pageant

7:00 p.m - Play "N" Hooky Pedal Tractor Pull on the Midway

7:00 p.m - Double-T Bullriding in the Arena

7:00 p.m - Karaoke Contest at Scotty's Pavilion

8:00 p.m - Miles Gee Band at Scotty's Pavilion

9:00 p.m - Sarah Beth Brewer Band at Scotty's Pavilion

11:00 p.m - Midway closes



SATURDAY, AUGUST 8

Weekend Full of Fun Starts Here



8:00 a.m - 10:00 a.m.

- Home & Garden Department, Farm Crops, FFA, and 4-H entries to be checked out

5:30 p.m - Gates Open

5:30 p.m - Midway opens with rides provided by Miller Spectacular Shows

5:30 p.m - Hopkins County Fair Toddler Pageant

5:30 - 11:00 p.m - Helicopter Rides (not included in admission)

6:00 p.m - Mark Comley Magic Show on the Midway until 10:00 p.m.

7:00 p.m - Karaoke Finals at Scotty's Pavilion

7:00 p.m - Demolition Derby in the Arena

10:00 p.m - \$1,000 Prize Money Drawing at Scotty's Pavilion

11:00 p.m - Midway closes

FOLLOW US ON SOCIAL MEDIA

Stay up to date with all fair fun information!



2026 DIAMOND SPONSORS

Thank You for Sponsoring the 2026 Hopkins County Fair



Owensboro
Health

CLAAS
FARMPOINT

SCOTTY'S

CONTRACTING + STONE

2026 GOLD & SILVER SPONSORS

Thank You for Sponsoring the 2026 Hopkins County Fair



e.**HOFMANN**

PLASTICS



carhartt®



PPL companies

2026 BRONZE SPONSORS

Thank You for Sponsoring the 2026 Hopkins County Fair

First United Bank and Trust Co

Atmos Energy

Clean Green

Independence Bank

Old National Bank

Huggins Haven RV Campground

Madisonville Community College

Kentucky Farm Bureau Jarrett Brown

Hilary's

Max Arnold & Sons

McEnaney McDonalds

Millay Orthodontics

Tara Edwards - Edward Jones

2026 SUPPORTER SPONSORS

Thank You for Sponsoring the 2026 Hopkins County Fair

Addicted 2 Change Motorsports

Catering & Creations

A & B Sign

2026 IN-KIND SPONSORS

Thank You for Sponsoring the 2026 Hopkins County Fair

Land O Frost

Rural King

Basham Farms

MILLER SPECTACULAR SHOWS LLC

Family fun for everyone!



CREATING FUN IS SERIOUS BUSINESS

OUTDOOR ADVENTURES and a lifetime of memories ▶ BEGIN HERE



877-243-5280
270-821-4171

www.visitmadisonvilleky.com



Hopkins County Tourist &
Convention Commission



2026 LIVESTOCK SHOW SCHEDULE

FRIDAY, JULY 31

- **RABBIT SHOW**

Check In 4:00 p.m. - 6:00 p.m.

Judging 6:00 p.m.



SATURDAY, AUGUST 1

- **POULTRY SHOW**

- **MARKET GOAT SHOW**

- **MARKET LAMB SHOW**

Check In 4:00 p.m. - 6:00 p.m.

Show 6:00 p.m.



TUESDAY, AUGUST 4

- **SWINE SHOW**

Check In 4:00 p.m. - 6:00 p.m.

Show 6:30 p.m.

THURSDAY, AUGUST 6

- **CATTLE SHOW**

Check In 4:00 p.m. - 6:00 p.m.

Show 6:30 p.m.



Calhoun's Pet Store



Grooming Center





Jennifer Trujillo
Michelle Hobbs
Groomer
545 Nebo Road 270.825.3108



Pet Wash

Hours
Monday-Friday
8am - 5:30pm
Saturday
8am - 5pm

Pet Show

Friday, August 7, 2026  10:00 a.m.  Ballard Center

OFFICIAL ENTRY FORM

Pet may be entered in 3 of the following categories:

1. Pet that most resembles its master (costume accepted)
2. Best trained pet (must perform on stage)
3. Pet with the most impressive eyes
4. Blackest pet
5. Whitest pet
6. Pet with longest ears
7. Pet with the curliest tail
8. Most unusual pet
9. Biggest pet
10. Smallest pet

My name is: _____

Age: _____

My pet's name is: _____

Type of pet: _____

My pet likes to: (1) _____

(2) _____

(3) _____

PRIZES:

1st Place in each category \$10.00 Gift Certificate

**PET MUST BE OWNED BY EXHIBITOR
AND MAY SHOW ONE 1 PET !!!**

ONLY Hopkins County children 12 years and under are eligible to enter their pet in the show.
Entry form must be in by Thursday, August 6th at noon at Calhoun's Pet Store

HOME AND GARDEN DIVISION

Amy Thomison, Vicki Thomison, and Carrie Seymore
General Superintendents

The Home and Garden division at the Hopkins County Fair is the perfect opportunity for community members to showcase their creativity and hard work! Held in the exhibit hall, this exciting event invites you to bring in your personal items to be displayed and judged in seven fun categories: Textiles, Arts & Crafts, Antiques & Collectibles, Canning, Baked Goods, Fresh Floral, and Fruits & Vegetables. Plus, you'll find incredible displays from the 4-H department, FFA, and farm crops all in one place. For those with a passion for excellence, the Hopkins County Fair Board will present the coveted "Best of Fair" award to the top entry in the Home and Garden Department, with the winner not eligible to claim the trophy again for three years. And, don't miss the chance to earn a Grand Prize ribbon for Best of Show in any of the categories: Textiles, Arts & Crafts, Antiques, Canning, Baked Goods, Floral, or Fruits & Vegetables. Bring your best creations and be part of the fun—let's make this year's fair the best yet!

Rules

1. All entries, except Flowers and Baked Goods, must be checked in between 9:00 a.m. and 6:00 p.m. on Monday, August 3, 2026.
2. Flowers and Baked Goods must be checked in between 9:00 a.m. and noon on Tuesday, August 4, 2026.
3. All entries must be checked out on Saturday, August 8, 2024, between 8:00 and 10:00 a.m.
4. Check-in stubs must be turned in when checking out, and the Superintendent or assistants will retrieve items from the shelves.
5. Prizes and ribbons will be forfeited if an exhibit is removed without proper check-out.
6. Judging for the Home and Garden Department will occur on August 4, 2026, and the judges' decisions are final. The building will be closed to the public while judging is taking place. A
7. Exhibits that have previously won first place may not be entered again.
8. Only one prize per class can be awarded to an individual.
9. Items not listed may still be entered but will only be judged if there are three or more entries of that type.
10. All items, except antiques, must be made by the person whose name they are entered under.
11. All handwork in Textiles must have been created within the last two years.
12. Numbered paintings will not be accepted.
13. Box mixes, commercial baking, and canned fillings will not be allowed.
14. All canned food must be in standard glass jars with USDA-approved lids.
15. Only entered items may be displayed.
16. Baked goods must be in a disposable container and sealed in a plastic bag.

Premiums Offered

| | |
|--------------|--------|
| First | \$5.00 |
| Second | \$4.00 |
| Third | \$3.00 |

TEXTILES

AWARD: An award for Best of Textiles will be presented.

100. Apron, Most Attractive
101. Apron, Most Serviceable
102. Christmas Article
103. Clothing/Wearable Article
104. Counted Cross Stitch
105. Crochet Item
106. Crocheted Article
107. Cross Stitch Article, Other
108. Decorated Item
109. Hand-embroidered Item
110. Handmade Doll Clothes
111. Handmade Doll or Toy
112. Handmade Garment
113. Handmade Totebag/Purse/Backpack
114. Holiday Article
115. Infant Article
116. Knitted Item
117. Machine Embroidered
118. Macramé
119. Monogramming
120. Novelty Garment
121. Pillow
122. Pillowcase
123. Place Mats
124. Potholder
125. Quilt Top, Appliqued
126. Quilt Top, Cross-Stitch
127. Quilt Top, Embroidered
128. Quilt Top, Pieced
129. Quilt, Applique
130. Quilt, Baby
131. Quilt, Block
132. Quilt, Cross Stitch
133. Quilt, Embroidered
134. Quilt, Hand-quilted
135. Quilt, Machine-quilted
136. Quilt, Novelty
137. Quilt, Patchwork
138. Quilt, Pieced
139. Quilt, Pieced and Appliqued
140. Quilt, Printed Fabric

141. Quilt, T-Shirt
142. Quilt, Tied or Tacked
143. Rug
144. Sampler
145. Spinning
146. Table Runner
147. Towel
148. Wall Accessory
149. Wall Hanging
150. Weaving

65+ years old Section for Textiles

The following classes in Textiles are made for handwork that has been made by a person 65 years of age or older. An award will be presented by Kesterson's Antiques.

160. Knitted Item
161. Novelty Garment
162. Pillow
163. Quilt Top, Appliqued
164. Quilt Top, Cross-Stitch
165. Quilt Top, Pieced
166. Quilt, Applique
167. Quilt, Cross Stitch
168. Quilt, Pieced
169. Quilted Article
170. Quilted Wall Hanging
171. Wall Hanging

ARTS & CRAFTS

AWARD: Hopkins County Fair Board will present an award to the person winning Best of in Arts and Crafts.

All pictures must be framed or matted. Painting must be done by person entering it and he or she may not be a professional. (Only one enter to a class per person)

- 200. Basket, Handwoven, Large
- 201. Basket, Handwoven, Small
- 202. Broom-Making
- 203. Calligraphy
- 204. Card Making, Handmade
- 205. Christmas Article, Handmade
- 206. Collage – Any Medium
- 207. Creative Stitchery, Free Hand
- 208. Cricut Item
- 209. Decorated Gourd
- 210. Decorated Hat
- 211. Decoration, Any Other Material
- 212. Decoration, Holiday
- 213. Decoration, Textile
- 214. Decoration, Woodcraft
- 215. Drawing, Charcoal
- 216. Drawing, Crayon
- 217. Drawing, Ink
- 218. Drawing, Pencil
- 219. Drawings, Markers
- 220. Flower Arrangement, Non-Living
- 221. Hand Painted Design on Article
- 222. Handmade Furniture
- 223. Handmade Jewelry
- 224. Handmade Wild Animal Call
- 225. Hobby
- 226. Holiday Article
- 227. Homemade Frame
- 228. Leather Craft
- 229. Mixed Medium, Any Article
- 230. Painted Article
- 231. Painting, Acrylic
- 232. Painting, Oil
- 233. Painting, Pastel
- 234. Painting, Watercolor
- 235. Photography, Black and White
- 236. Photography, Color

- 237. Pottery
- 238. Recycled Art
- 239. Scrapbook – 2-page Spread
- 240. Sculpture – Wood, Stone, or Any Carved Medium, Except Clay
- 241. Stained Glass Article
- 242. Stamping
- 243. Stencil on Article
- 244. Wood Burning
- 245. Wood Carving
- 246. Wreath

Youth

The Janice Glover Youth Art Award will be presented to the person winning Best of in Youth Art

All entries must be matted and framed.

- 260. Art, Crayon
- 261. Art, Painting
- 262. Art, Pencil
- 263. Art, Photography
- 264. Youth, Art
- 265. Youth, Hobby

ANTIQUES & COLLECTIBLES

AWARD: An award for Best Antiques of Show will be presented in memory of Rena Adams, Helen Dickerson and Margaret Edwards by their families.

Judging will be done on basis of quality or how well the item is preserved. All items must be at least 75 years-old, unless otherwise noted. One entry per person. Must be present to enter item.

- | | |
|--|--|
| 300. Aluminum Item, Hammered | 339. Letters |
| 301. Antique Lamp | 340. Madisonville/Hopkins Co. Advertising Item (Small) |
| 302. Basket, Glass or Porcelain/China | 341. Milk Bottle, Glass |
| 303. Basket, Woven | 342. Milk Glass |
| 304. Bell, Glass | 343. Oddities & Novelties |
| 305. Bells | 344. Painted Bowl |
| 306. Books | 345. Perfume Bottle, Glass (Not Manufacturer's Bottle) |
| 307. Bottles | 346. Photographs |
| 308. Butter Dish | 347. Pitcher, China |
| 309. Butter Mold | 348. Pitcher, Clear |
| 310. Cake Plate | 349. Pitcher, Colored Glass |
| 311. Candle Holders | 350. Pitcher, Small |
| 312. Canning Jar, Standard | 351. Platter |
| 313. Carnival Glass | 352. Postcard |
| 314. Cast Iron | 353. Powder Dish |
| 315. Celery Dish | 354. Pressed Glass |
| 316. China Teacup & Saucer | 355. Quilt |
| 317. Clear Bowl | 356. Relish Dish |
| 318. Clear Cake Stand | 357. Rolling Pin |
| 319. Clear Preserve Stand | 358. Salt & Pepper Shakers |
| 320. Clothes | 359. Shaving Mug |
| 321. Coins | 360. Spoon Holder |
| 322. Colored Bowl | 361. Sugar Bowl & Creamer |
| 323. Compote, Large | 362. Sugar Bowls |
| 324. Compote, Small | 363. Tea Pot |
| 325. Cookie Jar | 364. Tin Item |
| 326. Copper or Brass Articles | 365. Tool, Small Metal |
| 327. Depression Glass | 366. Tool, Small Wooden |
| 328. Dishes, Miscellaneous | 367. Toothpick Holder |
| 329. Documents | 368. Toys |
| 330. Framed Pictures | 369. Trinket Box |
| 331. Goblet | 370. Tumblers, Water Glasses |
| 332. Handwork | 371. Vase |
| 333. Insulator | 372. Vinegar Cruet |
| 334. Iron, Flat | 373. Wood Item |
| 335. Ironstone China | |
| 336. Jewelry | |
| 337. Keepsakes | |
| 338. Kitchen Utensil (Over 75-years-old) | |

CANNING

AWARD: An award for Best Canning will be presented in memory of Lucille Cardwell, by her granddaughter.

All canned foods must be exhibited in standard glass jars with USDA approved lids. Half-pints, pints, and quarts accepted unless otherwise stated.

All canned foods must follow USDA guidelines, which are available at the Hopkins County Extension Office. Sauces can not be judged if dairy products are in it. All lids must be two-piece lids in order to be judged. Do not can fruit with skin on. White peaches can not be canned per National Center for Home Food Preservation.

Fruits & Vegetables

- 400. Apples
- 401. Applesauce
- 402. Beans, Green
- 403. Beans, Shellie
- 404. Beets, Baby
- 405. Beets, Canned
- 406. Blackberries
- 407. Carrots
- 408. Collection of Canned Fruit (4 Kinds, 4 Jars)
- 409. Collection of Canned Vegetables (4 Kinds, 4 Jars)
- 410. Corn, Pint Only
- 411. Kraut
- 412. Limas, Baby
- 413. Limas, Large
- 414. Misc. – Pie Filling
- 415. Misc. – Sauces
- 416. Miscellaneous
- 417. Okra
- 418. Peaches
- 419. Pears
- 420. Peas, Black-eyed
- 421. Peas, English
- 422. Potatoes
- 423. Salsa
- 424. Soup Mixture
- 425. Tomato Catsup, Ripe
- 426. Tomato Juice
- 427. Tomatoes

Jam

- 428. Blackberry
- 429. Blueberry
- 430. Grape
- 431. Miscellaneous
- 432. Mixed Fruit
- 433. Peach
- 434. Plum
- 435. Raspberry
- 436. Strawberry

Jelly

- 437. Apple
- 438. Blackberry
- 439. Blueberry
- 440. Cherry
- 441. Grape
- 442. Miscellaneous
- 443. Mixed Fruit
- 444. Peach
- 445. Plum
- 446. Raspberry
- 447. Strawberry

Pickles

- 448. Beets
- 449. Chili Sauce
- 450. Chow Chow
- 451. Corn Relish
- 452. Okra
- 453. Pickled Pepper
- 454. Pickles, Bread & Butter
- 455. Pickles, Cucumber – Sour
- 456. Pickles, Cucumber Sweet
- 457. Pickles, Dill
- 458. Pickles, Green Tomato
- 459. Pickles, Miscellaneous
- 460. Pickles, Mixed
- 461. Pickles, Peach
- 462. Pickles, Pear
- 463. Pickles, Squash
- 464. Plum
- 465. Relish, Pepper
- 466. Relish, Sweet

Preserves

- 467. Apple
- 468. Apple Butter
- 469. Cherry
- 470. Conserves, Any Kind
- 471. Grape
- 472. Miscellaneous
- 473. Mixed Fruit
- 474. Peach
- 475. Pear
- 476. Plum
- 477. Strawberry
- 478. Watermelon

BAKED GOODS

AWARD: Hopkins County Homemakers will present an award to the person winning Best of Baked Goods

All baked goods must be entered on a disposable container in a sealed/zipped plastic bag.

- 500. Biscuits, 4
 - 501. Bread, Fruit, 4 slices
 - 502. Bread, Miscellaneous, 4 slices
 - 503. Bread, Nut, 4 slices
 - 504. Bread, Quick, 4 slices
 - 505. Bread, Reduced or Sugar Free, 4 Slices
 - 506. Bread, Sourdough, 4 slices
 - 507. Bread, Starter, 4 slices
 - 508. Bread, Zucchini, 4 slices
 - 509. Cake, Angel, Not Iced, 1/2 cake
 - 510. Cake, Chocolate, Iced, 1/2 cake
 - 511. Cake, Coffee, 1/2 cake
 - 512. Cake, Decorated, Whole
 - 513. Cake, Jam, Iced, 1/2 cake
 - 514. Cake, Miscellaneous, 1/2 cake
 - 515. Cake, Poundcake, 1/2 cake
 - 516. Cake, Reduced or Sugar Free, 1/2 cake
 - 517. Cake, Spice, 1/2 cake
 - 518. Candy, Any Other, 4
 - 519. Candy, Reduced or Sugar Free, 4
 - 520. Cinnamon Rolls, 6
 - 521. Cornbread, any shape, 4
 - 522. Cupcakes, Decorated, 4
 - 523. Cupcakes, Not Iced, 4
 - 524. Divinity, 4
 - 525. Fudge, Chocolate, 4
 - 526. Fudge, Miscellaneous, 4
 - 527. Fudge, Peanut Butter, 4
 - 528. Muffins, Fruit, 4
 - 529. Muffins, Miscellaneous, 4
 - 530. Muffins, Nut, 4
 - 531. Pie, Chess, Whole
 - 532. Pie, Chocolate, Whole
 - 533. Pie, Fruit, Whole
 - 534. Pie, Miscellaneous, Whole
 - 535. Pie, Nut, Whole
 - 536. Pie, Reduced or Sugar Free, Whole
 - 537. Plate, Brownies, Iced, 4 3-inch
 - 538. Plate, Brownies, Not Iced, 4 3-inch
 - 539. Plate, Cookies, Bar, 6
 - 540. Plate, Cookies, Chocolate Chip, 6
 - 541. Plate, Cookies, Miscellaneous, 6
 - 542. Plate, Cookies, Oatmeal, 6
 - 543. Plate, Cookies, Peanut Butter, 6
 - 544. Plate, Cookies, Raisin, 6
 - 545. Plate, Cookies, Reduced/Sugar Free, 6
 - 546. Plate, Cookies, Sugar, Not Iced, 6
 - 547. Pretzel
 - 548. Yeast Rolls, 4
- ## Youth
- 549. Bread, 4 slices
 - 550. Cake, Whole
 - 551. Candy, 4
 - 552. Cookies, 6
 - 553. Cupcakes, 4
 - 554. Pie, Whole

FRESH FLORAL

AWARD: In memory of Pennyroyal Master Gardeners, a special award will be given to the person displaying Best of Show in all floral divisions.

Rules:

1. Flowers must be checked in between 9:00 a.m. until noon on Tuesday, August 4, 2025.
2. Flowers must be homegrown in Hopkins County.
3. The Fair Board assumes no responsibility for damage or loss of property.
4. Each exhibitor must arrange the flowers he/she enters.
5. Containers must be checked out from 8:00-10:00 a.m., Saturday, August 8, 2025.
6. Foliage is allowed in all arrangement classes. No artificial or dried material will be accepted Fresh Florals.
7. A person may enter only one arrangement in any one class.
8. Horticultural specimens must be displayed in provided vases and must be grown by the exhibitor.

Cut Flower Arrangement

1. Design Featuring Black-eyed Susan
2. Design Featuring Gladioli
3. Design Featuring Large Marigolds
4. Design Featuring Small Marigolds
5. Design Featuring Roses
6. Design Featuring Sunflowers
7. Design Featuring Large Zinnias
8. Design Featuring Small Zinnias
9. Design Featuring Mixed Garden Flowers
10. Youth Design

Potted Plants

11. Flowering Potted Plant
12. Non-Flowering Potted Plant
13. Herb
14. Succulent
15. Dish Garden, Fairy Garden, Terrarium – Any of These Must Contain Live Plants
16. Multiple Plant Arrangement

Horticulture

17. Black-eyed Susan
18. Dahlia
19. Daylily
20. Gladiolus – One Large Spike
21. Marigold, Small
22. Marigold, Large
23. Rose
24. Sunflower
25. Zinnia, Large
26. Zinnia, Small
27. Other Garden Flower
28. Youth Entry

FRUITS & VEGETABLES

AWARD: Pennyroyal Master Gardeners will award the person earning the most points in Fruits & Vegetables.

NOTE: ALL PRODUCE (INCLUDING GARDEN DISPLAY) MUST BE CURRENT YEAR NON-COMMERCIALY GROWN CROPS EXCEPT DRIED GOURDS.

AWARD: Champion ribbon will be awarded to first place winner in the Garden Display class.

Garden Display pays: First...\$10.00 Second...\$8.00 Third...\$6.00

1. Apples, Any Color, Plate Of 5
2. Beans, Green, 12 With Stems
3. Beets, Plate Of 6
4. Blackberries, 6
5. Blueberries, 6
6. Cabbage
7. Cantaloupe
8. Corn, Sweet, White, 5 Shucked Roasting Ears
9. Corn, Sweet, Yellow, 5 Shucked Roasting Ears
10. Cucumbers. Pickling, Plate Of 5
11. Cucumbers, Slicing, Plate Of 5
12. Eggplant, Purple
13. Fruit, Any Other
14. Grapes, Blue, 2 Bunches
15. Grapes, White, 2 Bunches
16. Gourd, Dried, Largest
17. Gourd, Dried, Any Other
18. Gourd, Any Other
19. Gourd, Largest
20. Honey, Raw, Amber Light
21. Honey, Raw, Amber
22. Honey, Raw, Dark
23. Honey, Raw, With Comb
24. Okra, Plate Of 6
25. Onions, Red, Plate Of 5
26. Onions, White, Plate Of 5
27. Onions, Yellow, Plate Of 5
28. Peas, In Pod, 6
29. Peas, Shelled, 1/2 Cup
30. Pears, Plate Of 5
31. Peppers, Habanero, 5
32. Peppers, Hot, 5
33. Peppers, Jalapeño, 5
34. Peppers, Sweet, Banana, 5
35. Peppers, Sweet, Bell, 5
36. Potatoes, Red, 5
37. Potatoes, White, 5
38. Pumpkin, Field
39. Pumpkin, Largest
40. Pumpkin, Pie
41. Raspberries, 6
42. Squash, Acorn
43. Squash, Butternut
44. Squash, Cushaw
45. Squash, Spaghetti
46. Squash, Summer
47. Squash, Turban
48. Squash, White (Ruffled)
49. Squash, Zucchini
50. Tomatoes, Cherry (Any Color), Plate Of 5
51. Tomatoes, Green, Plate Of 5
52. Tomatoes, Red, Plate Of 5
53. Tomatoes, Roma, Plate Of 5
54. Tomatoes, Yellow, Plate Of 5
55. Tomatoes, Grape (Any Color), Plate Of 5
56. Tomatoes, Heirloom, Plate Of 5
57. Tomatoes, Largest
58. Turnips, Plate Of 5
59. Vegetable, Any Other
60. Vegetable, Unusual Shape
61. Watermelon, Largest
62. Garden Display* - Must Be Arranged On A Tray, Basket, Or Box With Only Fresh Fruit And Vegetables

DEPARTMENT OF FARM CROPS

AWARD: A trophy will be given in class 18.

1. Barley, Any Variety, Quart
2. Barley, Exhibit, 20 or more stalks
3. Corn, Yellow, Any Variety, 10 ears, (new) 2026
4. Corn, Yellow, Any Variety, 10 ears, (old) 2025
5. Corn, Yellow, Shelled, Quart
6. Corn, Yellow, 3 stalks
7. Corn, White, Any Variety, 10 ears, (new) 2025
8. Corn, White, Any Variety, 10 ears, (old) 2025
9. Corn, White, Shelled, Quart
10. Corn, White, 3 stalks
11. Crops, Any Other (All entries in same class)
12. Hay, Alfalfa(baled)*
13. Hay, Lespedeza (baled)*
14. Hay, Mixed (baled)*
15. Hay, Red Clover (baled)*
16. Hay, Sericea Lespedeza (baled)*
17. Hay, Timothy (baled)*
18. Horseweed, Tallest (Giant ragweed)
19. Oats, Any Variety, Quart
20. Oats, Exhibit, 20 or more stalks
21. Rye, Any Variety, Quart
22. Rye, Exhibit, 20 or more stalks
23. Seed, Ky. 31 Fescue, Quart
24. Seed, Lespedeza, Quart
25. Seed, Red Clover, Quart
26. Seed, Soybeans – Black, Green, Yellow, Quart
27. Soybeans, Yellow, 3 stalks
28. Sunflower, Head
29. Tobacco, Burley, 5 stalks on stick 3
30. Tobacco, Burley, bright leaf, 2 hands
31. Tobacco, Burley, flyings, 2 hands
32. Tobacco, Burley, lugs, 2 hands
33. Tobacco, Burley, primed, 2 hands
34. Tobacco, Burley, red leaf, 2 hands
35. Tobacco, Burley, Tips, 2 hands
36. Tobacco, Dark, 5 stalks on stick
37. Tobacco, Dark, heavy brown leaf, 2 hands
38. Tobacco, Dark, heavy red leaf, 2 hands
39. Tobacco, Dark, thin brown leaf, 2 hands
40. Wheat, Any Variety, Quart
41. Wheat, Exhibit, 20 or more stalks

* Not more than 1/3 bale of hay.

4-H & FFA COMMITTEE MEMBERS

Adult Agricultural Division

Byron Pruitt
General Superintendent
Chairman

Erik Reynolds
President of Hopkins County
Livestock Association, INC.

Jeremy McGill
County Extension Agent for
Horticulture

**Jake Brasher &
Shannon Brumfield**
County Extension Agent for 4-H
Youth Development

Gabriell & Ben Prevette
Hopkins County Central High
School Vo-Ag Dept.

**Brian Welch, Sara Edwards,
& Annagrace Ligon**
Madisonville North Hopkins High
School Vo-Ag Dept.

Debbie Boyd
Superintendent

4-H Club Home Economics Division

Paula Morrow
General Superintendent

Amanda Morrow
Assistant Superintendent

**Jake Brasher &
Shannon Brumfield**
County Extension Agent for 4-H
Youth Development

Sherri Friend
Program Assistant for 4-H Youth
Development

4-H Club Home Agricultural Division

**Jake Brasher &
Shannon Brumfield**
County Extension Agent for 4-H
Youth Development

**Byron Pruitt &
Erik Reynolds**
Adult Advisor

Paula Morrow
Superintendent

FFA Agricultural Division

Ben Prevette
Gabrielle Prevette
Brian Welch
Sara Edwards
Annagrace Ligon
Agriculture Teachers/
Adult Advisors



4-H CLUB ECONOMICS DIVISION

Paula Morrow
Superintendent

Amanda Morrow
Assistant Superintendent

Jake Brasher
County Extension Agent for 4-H Youth
Development

Sherri Friend
Program Assistant for 4-H Youth
Development

Paula Morrow & Amanda Morrow
Class/Division Assistants

Premiums Offered:

| Ribbon | Blue | Red | White |
|----------------------------|--------|--------|--------|
| Arts..... | \$5.00 | \$4.00 | \$3.00 |
| Canning..... | \$5.00 | \$4.00 | \$3.00 |
| Clothing..... | \$5.00 | \$4.00 | \$3.00 |
| Foods..... | \$5.00 | \$4.00 | \$3.00 |
| Home Improvement..... | \$5.00 | \$4.00 | \$3.00 |
| Knitting & Crocheting..... | \$5.00 | \$4.00 | \$3.00 |
| Photography..... | \$5.00 | \$4.00 | \$3.00 |

Rules:

1. Exhibitor must be a 4-H Club member in good standing
2. Club members may enter Arts, Canning, Clothing, Foods, Home Improvement, Knitting and Crocheting, and Photography
3. All entries must be checked in between 10:00 a.m. and 6:00 p.m. on Monday, August 3, 2025
4. Judging will be done on the Danish System
5. All entries must be checked out on Saturday, August 8, 2025 between 8:00 a.m. and 10:00 a.m.
6. Check-in stubs must be turned in when articles are checked out
7. Division trophies and awards will be given to the Hopkins County 4-H Club member in divisions where listed, receiving the most points. Points will be given as follows: Blue ribbon-3, Red ribbon-2, White ribbon-1. The same person cannot receive two trophies.
8. The Fair Board will present an award to the Hopkins County 4-H Club Member gaining the most cumulative points in the 4-H division. Members who have won the award before are not eligible to win again.
9. Premiums will not exceed the amounts listed above. (Amounts listed represent a maximum, not a minimum or a guarantee) Total money allotted to the 4-H Club Home economics will be \$600.00.

We've Gone Digital!

This year, we have went digital with our division sections. Below is a QR code that will direct you to the State 4-H page that will have all the current and up-to-date categories that are available. Paper copies are available at Hopkins County Extension office.



!SCAN ME!

4-H SPONSORS

**Thank you to our wonderful 2026
4-H Sponsors! Thank you for your
investment in our youth!**



!SCAN ME!

Follow us on Facebook to stay up to date!

4-H AGRICULTURE DIVISION - OUTSIDE

Premiums Offered

| Division | Blue | Red | White |
|-------------------|---------|---------|---------|
| Beef & Goats | \$30.00 | \$25.00 | \$20.00 |
| Lamb & Hogs | \$30.00 | \$25.00 | \$20.00 |
| Rabbits & Poultry | \$3.00 | \$2.00 | \$1.00 |

4-H Beef Department

AWARD: A trophy for the Champion Beef Steer, compliments of Hopkins County Livestock Association.

Judging of all beef cattle (4-H, F.F.A. and open Classes) on Thursday, August 7, beginning at 6:30 p.m. Beef 4-H and FFA will show together: (F.F.A. will show first in odd numbered years and 4-H will show first in even numbered years.) F.F.A. steers, 4-H steers, open Youth steers, F.F.A. showmanship, 4-H showmanship, F.F.A. Breeding Classes, 4-H Breeding Classes, open Breeding Classes. Exhibitors showing animals in Market Classes will weigh all entries at 5:00 p.m., Thursday, August 7.

CLASSES: Will be determined at the conclusion of weigh-in.

*Market animals will be weighed and an attempt will be made to have an approximately equal number of animals in each class.

*All exhibitors must show own animals with the exception of having more animals in a class than you can show.

Breeding Animals shown by breeds

CLASSES:

1. Junior Heifer Calf - calved Jan. 1-Apr. 30, 2025
2. Late senior Heifer Calf - calved Sept. 1-Oct. 31, 2024
3. Early senior Heifers - calved Oct. 1-Dec. 31, 2024
4. Late summer Yearling Heifers - calved July 1-Aug. 31, 2024
5. Early summer Yearling Heifers - calved May 1-June 30, 2024
6. Late Junior Yearling Heifers - calved Mar. 1-Apr. 30, 2024
7. Early Junior Yearling Heifers - calved Jan. 1-Feb. 28, 2024
8. Late senior Yearling Heifers - calved Nov. 1-Dec. 31, 2023
9. Early senior Yearling Heifers - calved Sept. 1-Oct. 31, 2023
10. Best producing Cow, any age with 2021 calf by side. Not eligible for Grand Championship. Calf may show in individual class.
11. Reserve Champion Female of the Breed.....Ribbon
12. Champion Female of All Breeds.....Ribbon and Halter
13. Reserve Champion Female, All Breeds . Ribbon and Halter
14. Best Bull of each Breed.....Ribbon

4-H Hog Department

AWARD: A trophy for Champion 4-H Market Hog will be presented by Land O' Frost, Madisonville, KY.

AWARD: Grand Champion 4-H Market Hog will receive \$300 from Land O' Frost, Madisonville, KY.

AWARD: Reserve Champion Market Hog will receive \$150 from Land O' Frost, Madisonville, KY.

AWARD: Third Place will receive \$50 from Land O' Frost, Madisonville, KY.

NOTE: County 4-H Agent will certify that entries or projects are part of supervised farming program of members. Exhibitors in the Youth swine division will be limited to not more than four head in the market class.

CLASSES:

1. Market Hogs, weighing up to 280 pounds

All market hogs will be weighed from 5:00 p.m. to 6:00 p.m. on Tuesday, August 5, 2025. Swine committee will assign weight classes. No market hogs are to be brought to the fairgrounds until Tuesday, August 5, 2025. Swine showmanship will be held beginning at 6:30 p.m., Tuesday, August 5, 2025, prior to judging of market hogs.

Market Hog Class Non-Terminal

AWARD: Exhibitors are limited to four market hogs weighing up to 280 pounds at weigh-in on Tuesday, August 5, 2025, 5:00 p.m. to 6:00 pm at the Hopkins County Fairgrounds.

Market hogs should have been farrowed no earlier than January 1, 2025 and should be in member's possession by May 1, 2025.

CLASSES: Will be determined at the conclusion of weigh-in.

4-H Market Lambs

AWARD: A \$25 gift card for Champion Market Lamb will be presented by Animal Medical Center – Dr. Walter Enright and Dr. Lauren Turley - Madisonville, KY.

To be entered beginning at 5:30 p.m., Saturday, August 2, 2025
To be judged following Goat Show., Saturday, August 2, 2025.
To be released after show.

Best Hopkins County born lamb - Ribbon only.

RULES:

Open to 4-H members engaged in an approved sheep project. All lambs must have been owned by June 1 of the current year. Ewes and wether lambs are eligible. All lambs must be shown by owner. Lamb will be shown by weight. Weight ranges 70-140 pounds and classes are to be broken after weigh-in is completed. Lambs may be entered in only one of the single classes, Lamb must be accompanied by an approved health certificate.

4-H Market Goat Show

To be entered and begin weighing at 4:00 p.m. Saturday, August 2, 2025.

To be judged at 6:00 p.m., Saturday, August 2, 2025. To be released following the show.

Classes are open to bona fide 4-H Members.

All goats must have been born after August 15, 2024. Goats will be shown by weights. No minimum weight.

Novice only eligible to show one goat in weight class.

Novice weight class winner is not eligible to show in Champion Class.

Novice weight will be eligible for premiums offered below.

Limit 4 animals per exhibitor.

Ducks, Geese, Guineas, and Turkeys

Rosettes will go to Grand Champion (\$20.00 Premium) and Reserve Champion (\$10.00 Premium)

NOTE : Poultry will be judged and released on same day.

RULES: Poultry Project must belong to the 4-H Member. The 4-H Member will need to be present at the Exhibit Cage during judging (4-H Member only). The 4-Her will be asked to remove the bird and speak about his or her project. The Judge will be allowed to ask questions of the 4-Her concerning their project. The Judge will be selecting a 4-Her as Champion for Showmanship.

To be entered between 4:00 and 6:00 p.m., Saturday, August 2, 2025.

To be judged at 6:00 p.m., Saturday, August 2, 2025.

To be released by 9:00 p.m., Saturday, August 2, 2025.

CLASSES:

1. Heavy Variety Breeds (Americana, Asiatic & English)
2. Light Variety Breeds (Mediterranean, French, Polish, Hamburg & Continental)
3. Clean Legged Single Comb Bantams
4. Clean Legged Rose Comb Bantams
5. Feather Legged Bantams
6. Old English & Modern Game Bantams
7. Pea Comb Bantams
8. All Other Comb Bantams
9. Turkeys
10. Guineas
11. Ducks
12. Geese
13. All Other Water Fowl

Classification:

Classes 1 Through 7 Will Show As Follows:

Cock - Hatched Before January, 2024.

Hen - Hatched Before January, 2024.

Cockerel - Hatched After December, 2023.

Pullet - Hatched After December, 2023.

Classes 9 Through 13 Will Show As Male And/or Female.

*Note: All Birds Must Be At Least 6-months-old

4-H Rabbit Department

AWARD: A trophy for Champion 4-H Market Hog will be presented by Land O' Frost, Madisonville, KY.

AWARD: Grand Champion 4-H Market Hog will receive \$300 from Land O' Frost, Madisonville, KY.

AWARD: Reserve Champion Market Hog will receive \$150 from Land O' Frost, Madisonville, KY.

AWARD: Third Place will receive \$50 from Land O' Frost, Madisonville, KY

NOTE: County 4-H Agent will certify that entries or projects are part of supervised farming program of members. Exhibitors in the Youth swine division will be limited to not more than four head in the market class.

CLASSES:

1. Market Hogs, weighing up to 280 pounds

All market hogs will be weighed from 5:00 p.m. to 6:00 p.m. on Tuesday, August 5, 2025. Swine committee will assign weight classes. No market hogs are to be brought to the fairgrounds until Tuesday, August 5, 2025. Swine showmanship will be held beginning at 6:30 p.m., Tuesday, August 5, 2025, prior to judging of market hogs.

FFA AGRICULTURAL DIVISION

Premiums Offered

Premiums to be paid on the danish system. Premiums to be paid will not exceed the schedule listed below.

| Division | Blue | Red | White |
|-----------------------|---------|---------|---------|
| Beef, Lamb, & Hogs | \$30.00 | \$25.00 | \$20.00 |
| Crops | \$4.00 | \$3.00 | \$2.00 |
| Garden & Horticulture | \$4.00 | \$3.00 | \$2.00 |
| Farm Shop | \$4.00 | \$3.00 | \$2.00 |
| Rabbits & Poultry | \$4.00 | \$3.00 | \$2.00 |
| Garden Display | \$10.00 | \$8.00 | \$6.00 |

4-H Beef Department

RULES:

- Open to Hopkins County F.F.A. members.
- Exhibit must be part of student's agricultural program.
- F.F.A. member must have a project started at least 90 days prior to day of show.
- No registration papers will be required for F.F.A. classes. Members showing in open classes and have registration papers registered in own name.
- Same animals may not be shown in both breeding and meat classes.
- F.F.A. exhibitors will comply with health rules as set up for the fair.
- F.F.A. members will comply with other rules as set up for the fair except as noted in statements 4 and 5 above.
- F.F.A. exhibits judged on Danish system except as noted in classes.
- All premiums in this division will be distributed by advisors on Saturday morning.
- Each exhibitor will be limited to one money per class in crop, garden, and farm shop departments, and two in market hog class.
- All garden, crop and shop entries in place by 5:00 p.m., Monday, August 3, 2026.
- All market animal to be weighed at 5:00 p.m., Thursday, August 6, 2026.
- Market lambs must have been owned by the exhibitor by June 1st of the current year.
- All steers must have been nominated by April 1st of the current year to show at the Hopkins County Fair.
- The garden display ribbon will not count on the garden products trophy.
- Students may enter more than one crop or garden entry in each class, but only one ribbon will count on the trophy and the money from each class (except class 58)
- A refinished shop project will not be considered for a trophy.
- All hogs shall be owned by June 1st.
- The manager or superintendent of any department shall have the authority without liability or recourse to the Hopkins County Fair Board to bar any exhibitor, or his representative, in the event of a discourteous act to a judge or an official of the fair, and he shall have power to disqualify the entry of said exhibitor forfeits any prize money won.

FFA Livestock

Award will be determined on point system as follows: Blue Ribbon-3, Red Ribbon-2, and White Ribbon-1. Cattle Ribbons count double Swine Ribbons.

FFA Beef Cattle

Show order for Youth Beef shows: 4-H steers, F.F.A. steers, Open Youth Steer Show, 4-H Showmanship, F.F.A. Showmanship, 4-H Breeding, F.F.A. Breeding, Open Breeding. F.F.A. will show first in odd numbered years and 4-H will show first in even numbered years.

Breeding Cattle

(Same Classes For Each Breed)

CLASSES:

- Junior Heifer Calf - Calved Jan. 1- Apr. 30, 2025
- Late Senior Heifer Calf - Calved Nov. 1- Dec. 31, 2024
- Early Senior Heifer Calf - Calved Sept. 1- Oct. 31, 2024
- Late Summer Yearling Heifers - Calved July 1- Aug. 31, 2024
- Late Junior Yearling Heifers - Calved Mar. 1- Apr. 30, 2024
- Early Junior Yearling Heifers - Calved Jan. 1- Feb. 28, 2024
- Late Senior Yearlings Heifer - Calved Nov. 1- Dec. 31, 2023
- Early Senior Yearlings Heifers - Calved Sept. 1- Oct. 31, 2023
- Best Producing Cow, Any Age. With Calf By Side 250 Days Of Age Of Show Date. Not Eligible For Grand Championship. calf May Show In Individual Class.
- Champion Female Of Breed - Ribbon
- Reserved Champion Female Of The Breed - Ribbon
- Champion Female Of All Breeds - Ribbon
- Reserved Champion Female, All Breeds - Ribbon
- Best Bull Of Each Breed - Ribbon

4-H and F.F.A. Beef Showmanship Contests will be conducted immediately following the Open Youth Steer Show on Thursday August 6, 2025.

Market Animals

All market animals to be weighed at 5:00 p.m., Thursday, August 6, 2026. Animals will be assigned to classes by weight and not by breeds.

- Market steers – Classed by weight
- Champion of show
- Reserved Champion of show

NOTE: Only first and second place winner blue ribbon animals will be eligible to compete for championship.

OPEN YOUTH MARKET SHOW PREMIUMS OFFERED:

| | |
|-----------------|---------|
| First | \$15.00 |
| Second | \$10.00 |
| Third | \$6.00 |
| Fourth | \$4.00 |
| Fifth and sixth | \$2.00 |

FFA Crop Department

CLASSES:

18. Best 10 Ears Of Yellow Corn, Any Variety
19. Best 10 Ears Of White Corn, Any Variety
20. Best 3 Stalks Of White Corn, Any Variety
21. Best 3 Stalks Of Yellow Corn, Any Variety
22. Best 3 Stalks Of Soybeans, Any Variety (Include Roots)
23. Best 5 Stalks Of Burley Tobacco On Stick
24. Best 5 Stalks Dark Tobacco On Stick
25. Best 3 Hands Prime Burley Tobacco On Stick (20 Leaves Or more Per Hand)
26. Best Quart Of Wheat
27. Best Quart Of Any Crop Seed
28. Best Bale Of Mixed Hay
29. Best Bale Of Red Clover
30. Best Bale Of Lespedeza
31. Best Bale Of Alfalfa
32. Best Bale Of Grass Hay

The Championship Awards are made up of the highest total number points: Blue ribbon-3, red ribbon-2, and White Ribbon-1. (in case of a tie, judge will break the tie.)

FFA Farm Shop

CLASSES:

33. Best large Article made by F.F.A. member
34. Best medium Article made by F.F.A. member
35. Best small Article made by F.F.A. member

FFA Garden Department

Champion Award based on highest total number of points: Blue ribbon-3, red ribbon-2, and White ribbon-1.

Display not to exceed 3'x4' or 12 square feet surface area.

CLASSES:

37. Best Cabbage
38. Best 3 Eggplant
39. Best 3 Summer Squash
40. Best 3 Zucchini Squash
41. Best Acorn Squash
42. Best Spaghetti Squash
43. Best Scalloped White Squash
44. Best 5 White Potatoes
45. Best 5 Red Potatoes
46. Best Watermelon
47. Best Cantaloupe
48. Best Pumpkin
49. Best 12 Green Beans
50. Best 6 Carrots
51. Best Okra
52. Best 6 Beets
53. Best 5 Red Tomatoes
54. Best 5 Yellow Tomatoes
55. Best 4 Bell Peppers
56. Best 4 Banana Peppers
57. Best 4 Hot Peppers

58. Best 6 Slicing Cucumbers
59. Best 5 Onions, Any Variety
60. Best 6 Roasting Ears-white Sweet Corn
61. Most Unusual F.F.A. Decorated Vegetable
62. Best Garden Display, 6 Or More Grown By The Exhibitor
63. Best 5 Of Any Other Vegetable (Only One Money In This Class And Two Items Count On Trophy)

FFA Horticulture

CLASSES:

64. Best Cut Flowers By Horticulture Student
65. Best Potted Plant By Horticulture Student
66. Best Potted Shrub By Horticulture Student

FFA Hogs

AWARD: Grand Champion FFA Market Hog will receive \$300 from Land O' Frost, Madisonville, KY.

AWARD: Reserve Champion FFA Market Hog will receive \$150 from Land O' Frost, Madisonville, KY.

AWARD: Third Place FFA Market Hog will receive \$50 from Land O' Frost, Madisonville, KY students may show 4 hogs in the youth show.

CLASS:

67. Market Hogs (Barrows or Gilts) weighing 220-280 lbs. (F.F.A. shows first in odd numbered years, 4-H shows first in even numbered years.) The market Hog show will be Tuesday, August 5, 2025. All market hogs will be weighed at 4:00 - 6:00 p.m. The swine committee will assign animals to 4 weight classes, and attempt to have equal numbers of entries in each weight class. All hogs out of the above weight range will be evaluated separately.

The F.F.A. Hog showmanship Contest will be held Tuesday, August 5, 2025 at 6:30 p.m., prior to market Hog show.

Market Hog Class Non-Terminal Show

Exhibitors are limited to four market hogs weighing 220-280 lbs. at weigh-in Tuesday, August 6, 2024, 4:00-6:00 p.m. at Hopkins County Fairgrounds. Market hogs should have been farrowed no earlier than January 1, 2024.

PREMIUMS OFFERED:

| | |
|------------------|---------|
| First | \$15.00 |
| Second | \$10.00 |
| Third | \$8.00 |
| Fourth | \$6.00 |

FFA Seed Identification

CLASS:

68. Seed Identification

PREMIUMS OFFERED:

| | |
|------------------|--------|
| First | \$8.00 |
| Second | \$4.00 |
| Third | \$2.00 |
| Fourth | \$1.00 |

The contest will be held on Tuesday, August 5, 2025 at 11:00 a.m. and is open to any Hopkins County F.F.A. member.

FFA Rabbit Department

AWARD: Champion animal show (all breeds competing) – Rosette and \$5.00.

To be entered between 4:00 and 6:00 p.m., Friday, August 3, 2025.

To be judged at 6:00 p.m., Friday, August 1, 2025.

To be released at 9:00 p.m., Friday, August 1, 2025.

CLASSES:

- 1. Junior Buck
- 2. Junior Doe
- 3. Senior Buck
- 4. Senior Doe

PREMIUMS OFFERED:

| | |
|--------------------------------------|--------------------|
| First | \$3.00 |
| Second | \$2.00 |
| Third | \$1.00 |
| Champion of each breed | \$2.00 and Rosette |
| Reserve champion of each breed | Rosette |

Champion will be chosen only when as many as six animals are competing.

All rabbits will be cared for by the Fair and all feed is furnished by Rural King, Madisonville, KY.

FFA Poultry Department

CHICKENS OF ALL BREEDS, GAME BIRDS,
DUCKS, GEESE, GUINEAS AND TURKEYS

To be entered between 4:00 and 6:00 p.m., Saturday, August 2, 2025.

To be judged at 6:00 p.m., Saturday, August 2, 2025.

To be released by 9:00 p.m., Saturday, August 5, 2025.

CLASSES:

- 1. Heavy Variety Breeds (Americana, Asiatic & English)
- 2. Light Variety Breeds (Mediterranean, French, Polish, Hamburg & Continental)
- 3. Clean legged single comb Bantams
- 4. Cleaned legged rose comb Bantams
- 5. Feather legged Bantams
- 6. Old English & Modern Game Hens
- 7. All other comb Bantams
- 8. Turkeys
- 9. Guineas
- 10. Ducks
- 11. Geese
- 12. Game Birds (Quail, pheasants, etc.)

CLASSIFICATION:

Classes 1 through 7 will show as follows:

Cock – hatched before January, 2024

Hen – hatched before January, 2024

Cockerel – hatched after December, 2023

Pullet – hatched after December, 2023

Classes 8 through 12 will show as male and/or female.

All poultry will be cared for by the Fair and all feed is furnished by Rural King Madisonville, KY.

FFA Market Lambs

To be entered beginning at 4:00 p.m., Saturday, August 2, 2025.

To be judged at 5:30 p.m., Saturday, August 2, 2025 following Goat Show

To be released after the show.

Best Hopkins County Born lamb – Ribbon Only.

This is open to F.F.A. members engaged in an approved sheep project.

All lambs must be shown by owner.

Lambs will be shown by weight. Weight ranges are 70 to 140 pounds and classes are to be broken after weigh-in completed.

Lambs may be entered in only one of the single classes.

Lambs must be accompanied by an approved health certificate.

Ewes and wethers are both eligible to participate in the market lamb show.

LIVESTOCK HEALTH REQUIREMENTS

All livestock/animals offered for sale or exhibition at Kentucky County Fairs shall meet the following regulations according to KRS Chapter 257:

- a. 302 KAR 20:040 (Entry into Kentucky)
- b. 302 KAR 20:065 (Sale and exhibition of Kentucky origin animals in Kentucky)

Any questions concerning these health regulations should be directed to your local veterinarian or the Kentucky State Department of Agriculture Veterinarian's office at 502-573-0282.

Livestock Health regulations can be obtained on the Kentucky Department of Agriculture website:

<http://www.kyagr.com/statevet/animal-movement.html>

Please be advised that Livestock Health Requirements are subject to change at any time.

ADULT AGRICULTURE DIVISION

Open Youth Beef Cattle Department

AWARD: An award of \$50.00 will be given for the Grand Champion Female.

AWARD: An award of \$25.00 will be given for the Reserve Champion Female.

To be entered from 4:00 to 6:00 p.m. Thursday, August 8, 2024.

To be judged by 6:30 p.m. Thursday, August 8, 2024.

To be released after show.

Cattle leaving prior to release time without superintendent's permission shall forfeit prize money.

The following premiums shall apply to all classes listed in the Beef Cattle department except Championship Classes which shall receive a ribbon only. Space in cattle barn will be assigned by superintendent.

PREMIUMS OFFERED:

| | |
|--------------|---------|
| First | \$15.00 |
| Second | \$10.00 |
| Third | \$8.00 |
| Fourth | \$6.00 |

Open Beef Animals to be shown alphabetically (Angus, red Angus, Charolais, Herefords, polled Herefords, Limousine, Simmental, other breeds).

CLASSES:

1. Market Animal
2. Junior Heifer Calf - Calved Jan. 1-Apr. 30, 2026
3. Late Senior Heifer Calf - Calved Nov. 1-Dec. 31, 2025
4. Early Senior Heifer Calf - Calved Sept. 1-Oct. 31, 2025
5. Late Summer Yearling Heifers - Calved July 1-Aug. 31, 2025
6. Early Summer Yearling Heifers - Calved May 1-June 30, 2025
7. Late Junior Yearling Heifers - Calved Mar. 1-Apr. 30, 2025
8. Early Junior Yearling Heifers - Calved Jan. 1-Feb. 28, 2025

9. Late Senior Yearlings Heifer - Calved Nov. 1-Dec. 31, 2024
10. Early Senior Yearlings Heifers - Calved Sept. 1-Oct. 31, 2024
11. Best producing Cow, any age, with calf by side 250 days of age of show date. Not eligible for Grand Championship. Calf may show in individual class.
12. Champion Female Of Breed - Ribbon
13. Reserved Champion Female Of The Breed - Ribbon
14. Champion Female Of All Breeds - Ribbon
15. Reserved Champion Female, All Breeds - Ribbon
16. Best Bull Of Each Breed - Ribbon

Open Youth Beef Show

AWARD: An award of \$50.00 will be given for the Grand Champion.

AWARD: An award of \$25.00 will be given for the Reserve Champion.

To be entered and begin weighing at 5:30 p.m., August 7, 2025. To be released after the show. These classes are open to bona fide 4-H and/or F.F.A. members from any county.

Note: County 4-H agent or F.F.A. advisors will certify the entries, and 4-H and F.F.A. will show together.

PREMIUMS OFFERED:

| | |
|--------------|---------|
| First | \$15.00 |
| Second | \$10.00 |
| Third | \$8.00 |
| Fourth | \$6.00 |

Market Animal

All market animal to be weighed by 5:00 p.m., Thursday, August 7, 2025.

Animals will be assigned to classes by weight and not by breeds.

1. Market Animal – Measured by weight
2. Champion of show
3. Reserve Champion of show

Note: Only first and second place winner blue ribbon animals will be eligible to compete for championship.

Youth Sheep Breeding Show For Hopkins County 4-H & FFA Members Only

Show will be Saturday, August 2, 2025.

Show will begin at the conclusion of the goat show.

All breeds will show in classes together.

Exhibitors limited to a maximum of 4 entries in breeding show.

CLASSES:

1. Late born junior ewe lamb – born 2/15/43 and after
2. Early born junior ewe lamb – born 1/1/23-2/14/24
3. Yearling ewe – born 9/1/22-12/31/24
4. Aged ewe
5. Champion ewe
6. Reserve Champion ewe
7. Late born ram lamb – born 2/15/25 and after
8. Early born junior ram lamb – born 1/1/24-2/14/25
9. Yearling ram – born 9/1/24-12/31/25
10. Champion ram
11. Reserve Champion ram any county. 4-H and F.F.A. will show together.

Weight classes from 70 to 140 pounds.

Novice weight class may be less than a minimum of 70 pounds.

Novice only eligible to show one lamb in weight class.

Novice weight class winner is not eligible to show in Champion Class.

Novice weight will be eligible for premiums offered below.

Open Youth Market Lamb Show

AWARD: An award of \$50.00 will be given for the Grand Champion.

AWARD: An award of \$25.00 will be given for the Reserve Champion.

To be entered and begin weighing at 4:00 and 6:00 p.m., Saturday, August 2, 2025.

To be judged following Goat Show., Saturday, August 2, 2025.

To be released after the show. These classes are open to bona fide 4-H and/or F.F.A. members from any county. 4-H and F.F.A. will show together.

Weight classes from 70 to 140 pounds.

Novice weight class may be less than a minimum of 70 pounds.

Novice only eligible to show one lamb in weight class.

Novice weight class winner is not eligible to show in Champion Class.

Novice weight will be eligible for premiums offered below.

PREMIUMS OFFERED:

| | |
|--------------|---------|
| First | \$15.00 |
| Second | \$10.00 |
| Third | \$8.00 |
| Fourth | \$6.00 |

Showmanship

AWARD: Gift Card for Novice Showmanship sponsored by the Pruitt Family, Madisonville, KY.

AWARD: Gift Card for Junior 4-H Showmanship sponsored by Pruitt Family, Madisonville, KY.

AWARD: Gift Card for Intermediate Showmanship sponsored by Hopkins County Farm Bureau Federation, Madisonville, KY.

AWARD: Gift Card for Senior Showmanship sponsored by State Farm Insurance – John Zieba, Madisonville, KY.

Showmanship classes will be broken into divisions for novice, F.F.A. Juniors, F.F.A. Seniors, 4-H Intermediate, 4-H Juniors and 4-H Seniors. The judge will place the classes with an emphasis on alertness, courtesy, control of lamb and show ring behavior. Ribbon will be awarded.

Open Youth Market Hog Show

An award of \$50.00 will be given for the Open Youth Grand Champion Hog.

An award of \$25.00 will be given for the Open Youth Reserve Champion Hog

To be entered and weighed between 4:00 and 6:00 p.m., Tuesday, August 5, 2025.

To be judged Tuesday, 6:30 p.m., August 5, 2025.

Show open to all Exhibitors.

Market Hog Class Non-Terminal

(Weight must be between 220-280 lbs.)

CLASSES: Will be determined at the conclusion of weigh in.

PREMIUMS OFFERED:

| | |
|--------------|---------|
| First | \$15.00 |
| Second | \$10.00 |
| Third | \$8.00 |
| Fourth | \$6.00 |

Poultry Department

PLEASE PRE-REGISTER AT 270-821-3650

(NOTICE: All exhibitors in the open division must call the Hopkins County Extension Office at 270-821-3650 by July 26 TH and report the number of entries they will have in each class they plan to enter.)

CHICKENS OF ALL BREEDS, PIGEONS, DOVES, GAME BIRDS, DUCKS, GEESE, GUINEAS AND TURKEYS

AWARD: A trophy will be presented to Overall Best Water Fowl in honor of Monika Brewer.

NOTE: All poultry will be judged and released on same day.

To be entered between 4:00 and 6:00 p.m., Saturday, August 2, 2025.

To be judged at 6:00 p.m., Saturday, August 2, 2025.

To be released by 9:00 p.m., Saturday, August 2, 2025.

Champions and reserve champion will be judged from the following: Classes 1 and 2; Classes 3 thru 8; Class 9; Class 10; Class 11; Class 12

CLASSES:

1. Heavy Variety Breeds (Americana, Asiatic & English)
2. Light Variety Breeds (Mediterranean, French, Polish, Hamburg & Continental)
3. Clean legged single comb Bantams
4. Clean legged rose comb Bantams
5. Feather legged Bantams
6. Old English & Modern Game Bantams
7. Pea comb Bantams
8. All other comb Bantams
9. Turkeys
10. Guineaas
11. Ducks
12. Geese
13. All other waterfowl

* Classes 9-13 must have at least 6 entries for Champion and Reserve Champion to be selected.

*Note: All birds must be at least 6 months old.

CLASSIFICATION:

Class 1 through 7 show as follows:

Pullet – Hatched after December, 2025

Cock – Hatched before January, 2026

Hen – Hatched before January, 2026

Cockerel – Hatched after December, 2025

Class 8 through 12 will show as male and/or female.

PREMIUMS OFFERED:

| | |
|--------------------------------|--------|
| First (see classes) | \$4.00 |
| Second (see classes) | \$3.00 |
| Third (see classes) | \$2.00 |
| Champion | \$5.00 |
| Reserve Champion | \$3.00 |

Rabbit Department

Trophy to be presented to overall best in Show (Open, 4-H and FFA competing); Sponsored by Scott settle and Daniel Miller

SPECIAL AWARDS: Grand Champion Animal of Show – Rosette and \$5.00 (All breeds competing).

NOTE : Rabbits judged and released on same day.

To be entered between 4:00 and 6:00 p.m., Friday, August 1, 2025.

To be judged from 6:00 p.m., Friday, August 1, 2025.

To be released by 9:00 p.m., Friday, August 1, 2025.

CLASSES:

1. Junior Buck
2. Junior Doe
3. Senior Buck
4. Senior Doe

PREMIUMS OFFERED:

| | |
|--|--------|
| First | \$5.00 |
| Second | \$4.00 |
| Third | \$3.00 |
| Champion of each breed | \$5.00 |
| Reserve Champion of each breed | \$4.00 |
| Overall Grand Champion rosette and | \$4.00 |
| Overall Reserve Champion rosette and | \$3.00 |

Open Youth Market Goat Show

An award of \$50.00 will be given for the Grand Champion.

An award of \$25.00 will be given for the Reserve Champion.

To be entered and begin weighing at 5:00 p.m., Saturday, August 2, 2025.

To be judged at 6:00 p.m., Saturday, August 2, 2025.

To be released following the show.

Classes are open to bona fide 4-H and/or F.F.A. members from any county. 4-H and F.F.A. will show together.

All goats must have been born after August 15, 2025.

Goats will be shown by weights.

No minimum weight.

Novice only eligible to show one goat in weight class.

Novice weight class winner is not eligible to show in Champion Class.

Novice weight will be eligible for premiums offered below.

Limit 4 animals per exhibitor.

PREMIUMS OFFERED:

| | |
|------------------|---------|
| First | \$15.00 |
| Second | \$10.00 |
| Third | \$8.00 |
| Fourth | \$6.00 |

Showmanship classes will be as follows: Novice, Junior, Intermediate and Seniors.

2026 HOPKINS COUNTY FAIR PAGEANT SPONSORS

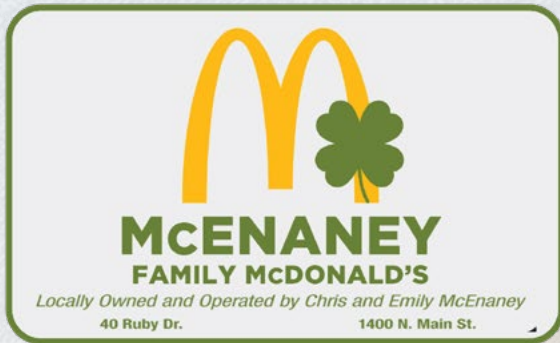

Jarrett Brown

463 E Center St
Madisonville, KY 42431

(270) 821-0405



KENTUCKY FARM BUREAU



BIG ON COMMITMENT:



Tara Y Edwards, AAMS®
Financial Advisor

341 North Main
Madisonville, KY 42431
270-821-0143

MRS. HOPKINS COUNTY FAIR PAGEANT

FRIDAY, JULY 31, 2026 | 7:00 P.M.

**MRS. CONGENIALITY WILL BE SELECTED BY THE CONTESTANTS
AND WILL RECEIVE THE MRS. CONGENIALITY AWARD**

RULES

1. Contestant must be a Kentucky resident.
2. Contestant must be a natural born female, married, and can have children.
3. Birth certificate is required.
4. Contestant must be 22 years of age on October 31, of the year when local pageant is held at local fair.
5. Entry fee is \$50.00. Venmo: hopkinscofair or make checks payable to Hopkins County Fair.

Lindsey Hawkins

2025 Mrs. Hopkins County

CONTACT

**KATHY CARVER (270) 836-6751
ALYSSA BROWNING (270) 339-2654**

**FIND US ON FACEBOOK
MS/MRS HOPKINS COUNTY FAIR**



MS. HOPKINS COUNTY FAIR PAGEANT

FRIDAY, JULY 31, 2026 | 7:00 P.M.

**MS. CONGENIALITY WILL BE SELECTED BY THE CONTESTANTS
AND WILL RECEIVE THE MS. CONGENIALITY AWARD**

RULES

1. Contestant must be a Kentucky resident.
2. Contestant must be a natural born female, single, divorced, widowed and can have children.
3. Birth certificate is required.
4. Contestant must be 22 years of age on October 31, of the year when local pageant is held at local fair.
5. Entry fee is \$50.00. Venmo: hopkinscofair or make checks payable to Hopkins County Fair.

Alaina Scott

2025 Ms. Hopkins County

CONTACT

**KATHY CARVER (270) 836-6751
ALYSSA BROWNING (270) 339-2654**

**FIND US ON FACEBOOK
MS/MRS HOPKINS COUNTY FAIR**



MISS HOPKINS COUNTY FAIR PAGEANT

SATURDAY, AUGUST 1, 2026 | 7:00 P.M.

**MISS CONGENIALITY WILL BE SELECTED BY THE CONTESTANTS
AND WILL RECEIVE THE MISS CONGENIALITY AWARD**

RULES

1. Contestant must be a Kentucky resident.
2. Contestant must have reached their 16th birthday and cannot have reached their 22nd birthday by October 31, of the year when the local fair pageant is held at the local fair.
3. Contestant must be single, never married, never had any children, or had marriage annulled.
4. Entry fee is \$50.00. Venmo: hopkinscofair or make checks payable to Hopkins County Fair.

*Nataleigh Ashdan
Morck*

2025 Miss Hopkins County

CONTACT

ALYSSA BROWNING (270) 339-2654

**FIND US ON FACEBOOK
MISS HOPKINS COUNTY FAIR PAGEANT**



MISS PRE-TEEN HOPKINS COUNTY FAIR PAGEANT

MONDAY, AUGUST 3, 2026 | 7:00 P.M.

RULES

1. Contestant must be a Hopkins County resident.
2. Contestant must have reached their 8th birthday by June 30 and cannot have reached their 13th birthday by October 31, of the year when the local fair pageant is held.
3. Contestant will wear and be judged in an age-appropriate evening gown and t-shirt/short outfit.
4. Entry fee is \$50.00 to be due by the date of the 1st pageant rehearsal on July 29. Venmo: hopkinscofair or make checks payable to Hopkins County Fair.

Journi Slaton

2025 Miss Pre-Teen Hopkins County

CONTACT

KATHY CARVER (270) 836-6751

**FIND US ON FACEBOOK
MISS PRETEEN HOPKINS COUNTY PAGEANT**



MISS TEEN HOPKINS COUNTY FAIR PAGEANT

TUESDAY, AUGUST 4, 2026 | 7:00 P.M.

RULES

1. Contestant must be a Hopkins County resident.
2. Contestant must have reached their 13th birthday by October 31st of the year when the local fair pageant is held.
3. Contestant must be single, never married, or never had any children.
4. Sponsor fee is \$50.00 to be due by the date of the 1st pageant rehearsal on July 29.
Venmo: hopkinscofair or make checks payable to Hopkins County Fair.

Brylee Zimmer

2025 Miss Teen Hopkins County

CONTACT

TONYA RICKARD (270) 339-6308

**FIND US ON FACEBOOK
MISS TEEN HOPKINS COUNTY**



LITTLE MISS & MISTER HOPKINS COUNTY FAIR PAGEANT

FRIDAY, AUGUST 7, 2026 | 7:00 P.M.

RULES

1. Contestant must be a Hopkins County resident.
2. Age 5 by June 30th and cannot have reached 8th birthday by June 30th, of the current year.
3. Applicants will appear as a couple and be judged as a couple.
4. Each couple will appear in competition with swim wear and dress wear. Must be age appropriate clothing. No long or "pageant" dresses for girls. No tuxedos for boys.
5. Entry fee is \$70.00. Venmo: hopkinscofair or make checks payable to Hopkins County Fair. Only one sponsor per couple.
6. Applicants must not have a professional manager or agent and must not have been contacted to perform or compete for monetary gain in anything other than an amateur contest.
7. If either winning contestant cannot compete at state level, the couple is disqualified and the runner up will become the winner.

*Piper Marks
Haken Little*

*2025 Little Miss & Mister
Hopkins County*

CONTACT

KELLIE HEADY (270) 871-6335

**FIND US ON FACEBOOK
LITTLE MISS & MISTER HOPKINS COUNTY**



HOPKINS COUNTY FAIR TODDLER PAGEANT

SATURDAY, AUGUST 8, 2026 | 5:30 P.M.

AGE GROUPS FOR BOYS & GIRLS

0 - 11 MONTHS

12 - 23 MONTHS

24 - 35 MONTHS

3 & 4 YEARS*

*Must not have reached 5th birthday by date of pageant

**Reigning winners cannot compete in the same age group again

RULES

1. Contestant must be a Hopkins County resident.
2. Contestant is to wear outfit of their choice. "Sundays Best"
3. Entry fee is \$25.00. Venmo: hopkinscofair or make checks payable to Hopkins County Fair. No cash accepted.
4. Must pre-register for pageant, no entries accepted at door.

FIRST 20 GIRLS AND 20 BOYS IN EACH AGE DIVISION WILL BE ACCEPTED

2025 WINNERS

0 - 11 Months

Charlie & Kohen

24 - 35 Months

Sophie & Dior

12 - 23 Months

Keaton & Josiah

3 - 4 Year Olds

Ellison & Malik

CONTACT

ASHLEY BROWNING (270) 871-6163

FIND US ON FACEBOOK

HOPKINS COUNTY FAIR BABY & TODDLER PAGEANT

2026 HOPKINS COUNTY FAIR ARENA SPONSORS



**HOPKINS COUNTY
FARM BUREAU**



MID-SOUTH TRUCK & TRACTOR PULL

JULY 31 & AUGUST 1 • 7:00 PM

HOPKINS COUNTY FAIR



WWW.MIDSOUTHPULLERSASSOCIATION.COM

STREET LEGAL TRUCK PULL



**HOPKINS COUNTY FAIR GROUNDS
MADISONVILLE, KENTUCKY**

JULY 31 2026

REGISTRATION START TIME 6 PM (PULL START TIME AFTER MID

SOUTH TRUCK PULL)

\$35 HOOK FEE

\$5 PIT PASS

1ST PLACE: \$4000

2ND PLACE: \$2000

3RD PLACE: \$1000

RULES

- ALL RULES OF PULL COORDINATOR AND HOPKINS COUNTY FAIR GROUNDS MUST BE OBSERVED
- ALL TRUCKS ARE SUBJECT TO RANDOM INSPECTION BY PULL COORDINATOR
- ALL RULES AND JUDGMENTS MADE BY PULL COORDINATOR ARE FINAL
- MUST PURCHASE DRIVER OR PIT PASS BRACELET AND HAVE SIGNED WAIVER TO BE IN PIT AREA
- ONLY PULLING TRUCKS AROUND IN ARENA (HAULING TRUCKS AND TRAILERS PARK BEHIND ARENA)
- OEM RUNNING GEAR 1 TON OR LESS
- DOT TIRES
- NO DROP BOXES
- NO HANGING WEIGHTS OR WEIGHT BRACKETS
- NO TRUSS FRAMES
- BUMP STOPS & AIR BAGS ARE ALLOWED
- MUST HAVE INSURANCE, LICENSE PLATE & TAG

CONTACT ALEX LAFFOON (270)-875-3384 OR LOGAN GULLEY (270)-399-5354 FOR INFORMATION OR QUESTIONS

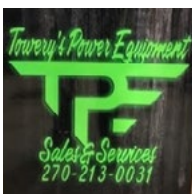

OVTPA

OHIO VALLEY TRACTOR PULLERS ASSOCIATION

SATURDAY, AUGUST 1 • 8:00 PM



**PURE POWER.
REAL SMOKE.
NON-STROP ACTION.**

FIND US ON FACEBOOK
**OHIO VALLEY
TRACTOR PULLERS ASSOCIATION**





Hot Air Balloon Rides

Monday, August 3
Tuesday, August 4

LOCATED OUTSIDE THE MORTON ST ENTRANCE
FREE WITH GATE ADMISSION

Hillside

ANTIQUE TRACTOR PULL



TUESDAY, AUGUST 4

7:00 PM

Hopkins County Fair



FARM STOCK 3 MPH 1ST GEAR

| | |
|------|------|
| 3500 | 5500 |
| 3750 | 6000 |
| 4000 | 6250 |
| 4250 | 6500 |
| 4500 | 7000 |
| 4750 | 7500 |
| 5000 | 8000 |

SUPER FARM STOCK 1ST GEAR 3.5 MPH RPD 20% NO CUT TIRES

| | |
|------|------|
| 3500 | 5500 |
| 3750 | 6000 |
| 4000 | 6500 |
| 4250 | 7000 |
| 4500 | 7500 |
| 5000 | 8000 |

REGULAR CLASS 1ST GEAR FULL CUTS 4MPH RPM 20%

| | |
|------|------------|
| 3500 | 18.4 TIRES |
| 3750 | 6000 |
| 4000 | 6500 |
| 4250 | 7000 |
| 4500 | 7500 |
| 5000 | |
| 5500 | |

OPEN CLASS 6-8-12 MPH

| | |
|------|------|
| 3750 | 5350 |
| 4250 | 5750 |
| 4750 | 6250 |

HOT RODS

5500 SM BLOCK
5500 BIG BLOCK

TOP CUT TIRES

| |
|------|
| 3500 |
| 3750 |
| 4000 |
| 4250 |
| 4500 |
| 5000 |
| 5500 |
| 6000 |

OPEN CLASS 5 MPH 16.9 TIRES & DOWN

| | | |
|------|------|------|
| 3750 | 4750 | 5750 |
| 4250 | 5350 | 6250 |

HOOK FEE \$25.00

3 HOOKS PER TRACTOR

MORE INFORMATION CONTACT:

HILLSIDE PULLERS 270-498-2926

GO-KART RACING HOPKINS CO FAIR

📍 135 MORTAN AVE MADISONVILLE, KY



\$500 TO WIN PER CLASS

CLASSES

JR PRO

CLONE
HEAVY

DUCAR/
PREDATOR
HEAVY

RWYB

\$35 ENTRY FEE

AUGUST 3RD

**HOPKINS
COUNTY
FAIR**



MOTOCROSS

RACING

**WEDNESDAY
AUG 5TH
2026**

**605 E Arch St
Madisonville, KY 42431**

Bike Classes:

- Stacyc 12eDrive
- Stacyc Open
- Fun 50
- 50cc Shaft
- 50cc Jr. (4-6)
- 50cc Sr. (7-8)
- 50cc Open
- 50cc Open Girls
- Mini E2
- EBike Open
- 65cc Beginner
- 65cc (7-9)
- 65cc (10-11)
- 65cc Open
- 85cc Beginner
- 85cc (7-11)
- 85cc (12-15)
- 85cc Open
- Supermini
- Open Girls
- Schoolboy (12-16)
- Collegeboy (17-24)
- Open Beginner (D)
- Open Novice (C)
- Open Intermediate (B)
- Open Pro (A) \$



- Open Outlaw
- 25+ \$
- 40+
- Pitbike

ATV Classes:

- Open Yard Quad
- 0-50cc Open
- 0-90 Open Youth
- ATV 200cc & Up

Schedule:
4pm-5pm Sign Up
5pm Practice
Heats to follow
Main Event 7:30pm

Race Fees:
\$30 Per Class

Gate Fee:
\$15 per person
Armbands must be
purchased by those
36" or taller
INCLUDES RIDES!!

Questions?
270.929.1335



**GUARANTEED 1ST-3RD
TROPHIES IN EVERY CLASS!
ALL 50CC & BELOW RACERS
RECEIVE AWARDS!**

www.fullpotentialracepromotions.com



Oval & Figure 8 Racing

Hopkins County Fair

August 6, 2026

Oval Race

| | |
|-----------------|-------|
| 1 st | \$700 |
| 2 nd | \$400 |
| 3 rd | \$150 |

Figure 8

| | |
|-----------------|-------|
| 1 st | \$700 |
| 2 nd | \$400 |
| 3 rd | \$150 |

Register at event • For more information, visit the Blue Collar Boys facebook page

DOUBLE-T CATTLE CO.

**AUGUST
7TH**

7:00



**BULLS &
BRONCS**



**FOLLOW DOUBLE-T CATTLE CO. LLC
FOR MORE INFORMATION**



SCAN ME

HOPKINS COUNTY FAIR Demolition Derby

August 8, 2026

Motor Swap Big Car

1st \$2,000
2nd \$1,000
3rd \$500

Cut & Go Small Car

1st \$900
2nd \$400
3rd \$250

MWFA vans/cars

1st \$700
2nd \$900
3rd \$200

Stock mowers 100% payback

PRESENTED BY

BLUE COLLAR



BOYS

Register at event • For rules and information, visit the Blue Collar Boys facebook page

2026 HOPKINS COUNTY FAIR MIDWAY SPONSORS



**OLD NATIONAL
BANK**

Clean Green
Portables, LLC

270-635-2701

When you need a place to go, call us!

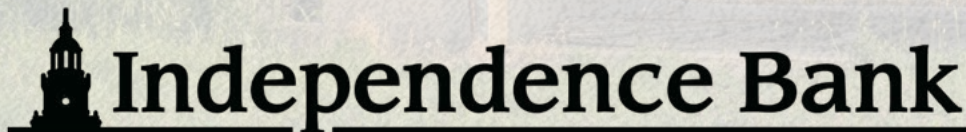



INSTANT ZEAL

**FRIDAY, AUGUST 8, 2025
TAKES STAGE AT 8:00 P.M.
SCOTTY'S PAVILION**

AUGUST 2ND - 6 PM

THE LIGHT
103.5

THE STONE FAMILY



ENTRY IS FREE!
after 5 PM

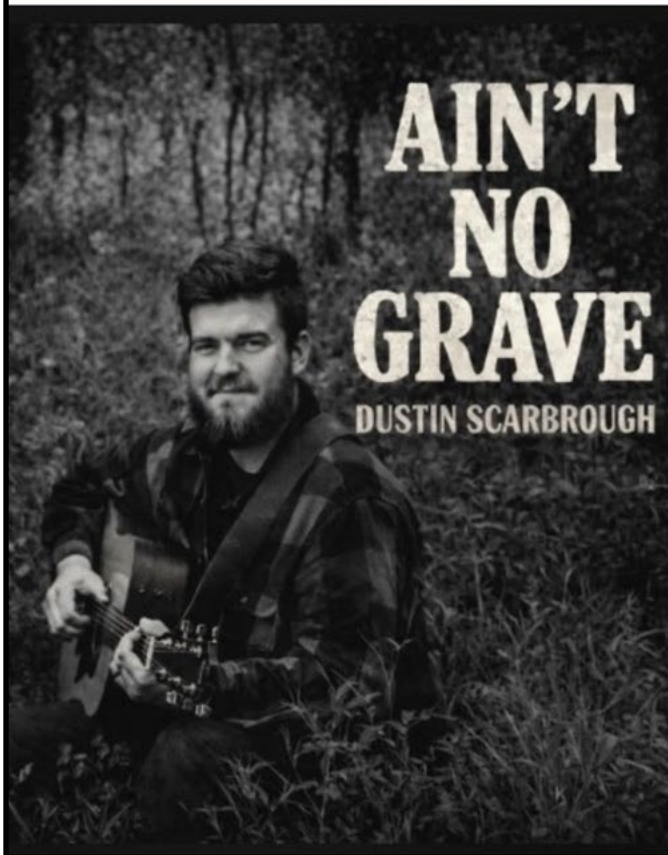

Austin Turner

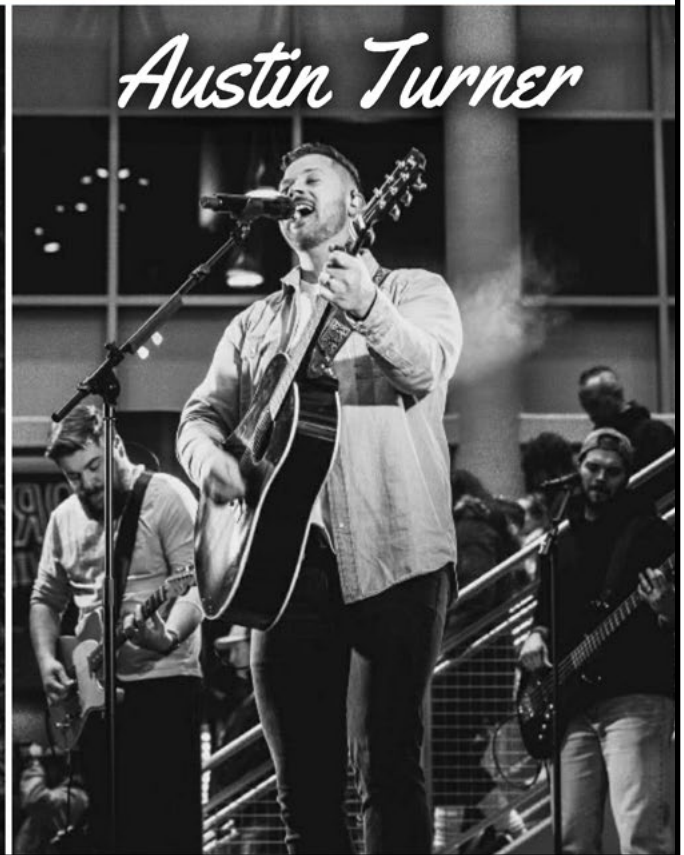



SARAH BETH BREWER

MILES GEE

AUGUST 7TH

MYLES AT 8:00 PM AND SARA BETH AT 9:00 PM

Madisonville... it's your turn to take the stage.

AUG 3 - 8



Hopkins County Fair KARAOKE CONTEST

Sing Your Way to the Finale!

August 3 - 7

Pre-register 6-7 PM, Contest begins at 7 PM

Each night one winner receives:

- \$50 Cash Prize
- Official Fair T-Shirt
- Winner's Medal

GRAND FINALE

August 8 • 7 PM

Nightly winners return to compete for:

- \$300 GRAND PRIZE**
- Trophy (courtesy of Champion Trophies)
- Professional Recording Session with Steve Baker



WHO WILL BE THE NEXT NASH RISING STAR?

Hopkins County Fair TALENT NIGHT

Music • Comedy • Dance • Variety Acts

Take the Stage. Show Your Talent.

PRE-REGISTER 6-7 PM

AUGUST 6 • 7 PM



One Stage. One Night. Endless Talent.
Presented by NASH 104.9



HOPKINS COUNTY
FAIR
MAGIC SHOWS!

A
MADISONVILLE
★ FAVORITE!



FUN
FOR ALL
AGES!

★ **SHOWS NIGHTLY** ★
MONDAY - SATURDAY



HELICOPTER RIDES

**JULY 31 • AUG 1 • AUG 2
AUG 6 • AUG 7 • AUG 8**

RIDES START AT \$30.00

SCHEDULE IS SUBJECT TO CHANGE



August 7, 2026

Registration
6:30 p.m.

Hook Time
7:00 p.m.

Pulling kids ages 3-12 and then a big kid / adult class to follow.





INVESTING IN OUR COMMUNITIES SINCE 1994

Since its founding in 1994, the LG&E and KU Foundation has been a catalyst for positive change across Kentucky and in select communities in Virginia. With a philanthropic focus on economic development, education, environmental stewardship, and diversity, the Foundation invests in initiatives that strengthen communities, empower individuals, and build a more inclusive and sustainable future.

Visit lge-ku.com/foundation to learn more.

LG&E and **KU**
Foundation



Home of the Healthiest You

270-825-2775

1128 North Main Street

AUTO ; HOME ; LIFE ; BUSINESS ; A MEMBER SERVICE ; KYFB.COM

Fairs come and go. But Jarrett is always here for you.



Insurance agents are a lot like friends, the best ones are always there when you need them. As your Kentucky Farm Bureau agent, Jarrett Brown will make sure you get the protection you need at a rate you can afford. And if you ever need him, he is just a phone call, email, or a short drive away. Because being “Big on Commitment” isn’t just a slogan, it’s his mission.

Jarrett Brown

463 E Center St
Madisonville, KY 42431

(270) 821-0405



KENTUCKY FARM BUREAU



BIG ON COMMITMENT.

Helping you maximize and develop your natural resource potentials.

- Environmental permitting
- Erosion Control
- Drainage Design & Construction
- Fencing



Crafting tomorrow's landscapes, today. Your trusted partner in land management excellence.

- Wildlife & Waterfowl Management Plans
- Land Clearing/Mulching
- Design & Construction of Ponds



270.452.2453 | www.naturalrms.com | Madisonville, KY |   

**Office
FURNITURE**



Solutions

COALFIELD
CUSTOM **DESIGNS**
SHIRT COMPANY
coalfelddesigns@gmail.com

2320 Anton Road
Madisonville, KY 42431
(270) 821-1660



Cabinets By Design

CUSTOM DESIGNS FOR YOUR KITCHEN BATH & FLOORS

3 Locations!

| | | |
|------------------------|----------------------------|----------------------------------|
| Madisonville | Providence | Henderson |
| 30 Bassett Ave. | 109 Montgomery Ave. | 459 Klutey Park Plaza Dr. |
| 270-825-0407 | 270-667-2555 | 270-826-2244 |

www.cabinetsbydesingky.com



Serving
Families
Since 1889

**HARRIS FUNERAL
HOME, INC.**

Call for
Your Pre-Need
Funeral or Cremation
Planning

134 North Main Street Madisonville KY 42431

(270) 821-6601

www.harrisfuneralinc.com

Proudly Veteran Owned and Operated



View & Share
our new guide
digitally by scanning
this QR code

Clean Green

Portables, LLC

270-635-2701

When you need a place to go, call us!

Edward Jones®

> edwardjones.com | Member SIPC

Build the future of your dreams with us.

At Edward Jones, we're in it for the long haul. We'll be with you every step of the way as you celebrate life's biggest milestones. Let us help you work toward them.

Contact us today to start creating a financial strategy tailored to your specific needs.



Tara Y Edwards
CFP®, AAMS®
Financial Advisor
Po Box 594
Madisonville, KY 42431
270-821-0143



EJB-8652F-A-E-AD AECSPAD 28872949



Built for where you're going.

CLAAS FARMPOINT™ is a mobile-first, technology-driven parts and equipment service provider built entirely around you and your farm — bringing you the solutions you need, when and where you need them.



Remote Services

With your permission, CLAAS FARMPOINT™ can access your machine and your data directly using our remote technology, delivering quicker response times for your maintenance and service requirements.



Mobile Parts Delivery

Need a part ASAP? Our technicians and parts runners are on it, strategically located and backed by our state-of-the-art parts replenishment program.



CLAAS On Your Farm Parts

The parts you need, right where you need them. We'll help you customize your very own selection of critical parts to keep on your farm, and you don't pay for what you use until after harvest.



Mobile Resident Technicians

When you call for help, we don't just send a technician. We send a CLAAS Academy-trained technician who's never far away from your machine — and they'll be supported every step of the way by our state-of-the-art Digital Service Manager system.



2560 Nebo Road, Madisonville, Kentucky 42431 | 270.841.8771
8497 US-31, Bunker Hill, IN 46914 | 765.867.8570

✉ FARMPOINT@CLAAS.COM
📱 @CLAASFARMPOINT

ANTIQUES



Kesterson's Corner

— Antiques, Curios and Collectibles —

GIGI KESTERSON SMITH

502 HALL STREET / MADISONVILLE, KENTUCKY 42431

PHONE: (270) 821-7311

Tue & Thur 2 - 4:30

Mon, Fri, Sat, 10 - 4:30



Auto Parts

55 N. Scott St
Madisonville, KY 42431
270-821-4261
napaonline.com



MCENANEY

FAMILY MCDONALD'S

Locally Owned and Operated by Chris and Emily McEnaney

40 Ruby Dr.

1400 N. Main St.



City of Hanson

Jimmy Epley, Mayor

Commission Members:

Brandon Marsh • Ann Lecornu
Emily Williams • Carroll Oakley

City Clerk/Treasurer

Christie Rainwater

Deputy City Clerk

Brian Jones

City Superintendent

Logan Rainwater

Laborers

John Betts • Hayden Clark
Ethan Pearson

Hopkins County Conservation District

USDA SERVICE CENTER
1095 National Mine Drive
Madisonville, KY 42431
270-821-4430 EXT. 3

BOARD OF SUPERVISORS

Chairman • Mark Herring
Vice Chairman • Jason Duncan
Treasurer • Mike Calhoun
Member • Gigi Smith
Member • Pate Weir
Member • Brian Lynn
Member • Jacob Dever



EMPLOYEES

-District Conservationist
Rachel Martin
-Administrative
Secretary Debbie Boyd

All **AMERICAN**
Towing & Recovery ^{LLC}

270-871-7887

Owners: Keith & Kimberly Tompkins

Office: 270-245-2370

Fax: 240-245-2524

Email: Allamericantowing01@yahoo.com

**35 Bassett Avenue
Madisonville, KY 42431**



KT
AUTO SALES ^{LLC}

270.452.2800

KT
AUTO SALES ^{LLC}

270.452.2800

250 East Arch Street • Madisonville, KY 42431

Ktauto250@yahoo.com

Owners: Keith & Kimberly Tompkins

PROUD SPONSOR OF THE 2026 HOPKINS COUNTY FAIR



**Jack Whitfield, Jr.
Hopkins County Judge-Executive**

**Ricky Whitaker - District 1
Buddy Cardwell - District 2
Vicki Thomison - District 3
Ronnie Noel - District 4**

**Billy Parrish - District 5
Charlie Beshears - District 6
Hannah Myers - District 7**



Proud Sponsor of the 2026 Hopkins County Madisonville Fair

Animal Medical Center

- *Small Animal Medicine & Surgery*
- *Boarding & Grooming Available*

Please call for an appointment.

Office Hrs. M-F 7am - 5:30pm • Sat 7am - 12 pm

Dr. Walter Enright • Dr. Lauren Turley

Dr. Jon Holloman



New Clients Always Welcome
1100 Island Ford Road, Madisonville, KY 42431
(270) 821-6349



**LUTZ APPRAISAL
SERVICE**

270-836-8186

karenlutz1@twc.com

PROUD SUPPORTER OF THE HOPKINS COUNTY FAIR!



**MADISONVILLE LOCATION
3444 HUBERT REID DR
MADISONVILLE, KY 42431
270-399-7654**

SCOTTY'S

CONTRACTING + STONE

Join Us At The
HOPKINS COUNTY FAIR

JULY 31-AUGUST 8, 2026



KENTUCKY STATE FAIR

AUGUST 20-30  **KY EXPO CENTER**

START
GO

HERE
ANYWHERE



FIND YOUR PROGRAM!



OUTSTANDING STUDENTS | OUTSTANDING TEAM | OUTSTANDING RESULTS

Hilary's

PROM ★ PAGEANT ★ HOCO ★ FORMAL



5 Star Electric delivers dependable, high-quality electrical services for commercial, industrial, and utility projects. With safety as our core value, we focus on doing the job right while protecting our people, partners, and communities.



Our Services

- Distribution
- Transmission
- Commercial & Industrial
- Substation
- Telecomm/Fiber
- Tower
- Storm Restoration and Emergency Response



270-664-3011

For More Information

www.5-starelectric.com

We're a Smart Plant.

Discover How We Do Things Differently.



Heavy Duty

Construction
Food Service
Chemical



Tamper Evident

Construction
Food Service
Chemical



Deli Containers

Food Service
Deli Counters
Grocery Stores



Portion Cups

Apple Sauce
Fruit Cups
Dipping Sauce/
Dressings



Trays

Produce
Fresh Meat
Seafood



For over 25 years, the goal at E. Hofmann Plastics Inc. has been to do better. We do this by doing things differently. We never settle. We're always exploring new technologies and seeking out innovative solutions to better serve our clients.

Contact us for more information about our full range of products.

51 Centennial Road, Orangeville, Ontario, Canada L9W 3R1

Tel: 519.943.5050 / 1.877.707.7245 • Fax: 519.938.5349 • www.hofmannplastics.com



ADDICTED2CHANGE

MOTORSPORTS

270-821-4817

LIFTS • WHEELS • TIRES • LED LIGHTING • AUDIO
TRUCK ACCESSORIES • PRESSURE WASHING
AUTOMOTIVE DETAILING



@ADDICTED2CHANGEMOTORSPORTS



Scan for info

1005 Pride Ave. Madisonville 270.452.2116

VISIT MADISONVILLELIVING.COM



**Kentucky Sports Factory-
Top tier training for athletes
of all ages and skill levels!**



**New Retail at the
Madisonville Town Center!**



AUG. 28



**Madisonville Illuminated
Hot Air Balloon Glow!**



**SEP.
25-26**



**Harvest Fest and the Hay
Bale Trail at Mahr Park!**

HANSON PHARMACY



Robert Cain, RPh

Free Delivery

7455 Hanson Rd
Hanson, KY

270-322-1234



Family Owned and Operated

Made Fresh Daily

Golden Glaze

Since 1967

*Bakery &
Deli*



67 N. Franklin Street,
Madisonville, KY.

270-821-7144

mike@goldenglaze.net

Max Arnold & Sons, LLC



MAXFUELXPRESS
DELI SNACKS DRINKS

bp



Commercial and Agricultural Fuel and Lubricants
2203 Anton Road • P.O. Box 453 • Madisonville, KY 42431
Phone: 270-821-4723 • Website: www.maxfuel.net



Shell



RELIABLE & RESILIENT



POWERING
HOPKINS COUNTY TODAY
FOR A BETTER TOMORROW

Follow us on Facebook!





We're more than excavating...

- Site Preparation
- Mine Construction
- Levee Construction
- Railway Construction
- Perpetual Material Handling



PROUD SPONSOR OF THE HOPKINS COUNTY FAIR!



IT'S NOT JUST A MORTGAGE.

IT'S HOME.

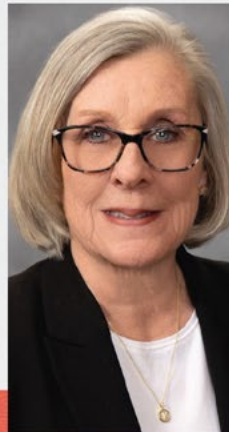

Independence Bank

MEMBER FDIC

KATHY PEYTON
(270) 452-0812
NMLS 686329

BUFFIE REYNOLDS
(270) 824-1476
NMLS 686330



**Know what's below.
Call before you dig.**

Call 811 at least two business days before digging so that utility-owned gas lines can be marked.



ATMOS
energy®





William R. Millay, DMD, MS

1410 Pride Avenue • Madisonville, KY 42431 • (270) 821-0123
108 W. Depot Street • Greenville, KY 42345 • (270) 338-0008

PROUD SPONSOR OF THE

2026 HOPKINS COUNTY FAIR



FIRST UNITED BANK
— AND TRUST COMPANY —

162 N Main St. | 1080 N Main St. | 101 E Main St.
Madisonville | Madisonville | Earlington

www.efirstunitedbank.com



**PLANNING YOUR
MENU FOR THIS
WEEK?**

**Catering
& Creations**
MEETING AND EVENT FACILITIES - YOUR PLACE OR OURS
270-836-5563

**WE WOULD LOVE
TO HELP YOU!**

THE MURPHY CONSTRUCTION GROUP

**SCOTT & MURPHY
INC.**

CIVIL & CONCRETE SPECIALISTS

SCOTT, MURPHY & DANIEL

BUILDING
CONSTRUCTION SPECIALISTS

**HARTZ
CONTRACTING**

100% EMPLOYEE OWNED

INDUSTRIAL • COMMERCIAL • INSTITUTIONAL • MEDICAL • CHURCHES

“YOUR ROAD TO A SUCCESSFUL PROJECT”

Ahlstrom-Munksjo Glass Fiber Tissue Facility

Design/Build Construction
Conventional General Contracting
Construction Management Services
Renovations / Conversions / Expansions
Complete Engineering
Architectural / Design Services

Joe Meyer
President

Derek Proffitt
Vice President

Jaime Crowell
Projects Manager

Webstaurant

Hopkins County Fair - Ballard
Convention Center

www.themurphyconstructiongroup.com
 Bowling Green, KY
 270.781.9944

SUPPORTING THE EFFORTS OF MADISONVILLE-HOPKINS COUNTY FOR OVER 40 YEARS



6320 Hanson Rd. Madisonville, KY 42431 270-322-8181
 5600 Old KY 54325 Salem Dr. Philpot, KY 42366 Owensboro, KY 42303 270-729-4721 270-684-8488

Power Machinery and Implement is now a part of Hagan's Outdoor Equipment family. We will still offer great service and top-quality equipment lines such as Kubota, Land Pride, Stihl, Bad Boy Mowers, and Cub Cadet equipment, but now from three locations serving Hanson, Philpot, and Owensboro, KY.



Kubota



STIHL®

- Mowing Equipment
- Compact Diesel Tractors
- Medium Size Farm Tractors
- Construction Grade Tractors
- Loader Backhoe Machines



KNIGHT & SONS

MONUMENT CO.

~ Since 1877 ~

Proudly Supports
Hopkins County Fair

276 W. Center St. 270-821-7553
www.knightmonuments.com



DPF Cleaning • Pick Up and Delivery

We build New Radiators and Oil Coolers, Charge
Air Coolers and Fuel Tanks, Steel or Aluminum

SERVICE
RADIATOR



INC.

75 Dempsey St. Madisonville, KY 42431
(270) 821-4232 Fax 270-821-8390 • serviceradiator.com
serviceradiator@bellsouth.net



Your Partner in Concrete. Your Partner in Community.

Young
CONCRETE
SUPPLY, LLC

270-836-9966 • 270-836-5544

1690 Hubert Reid Rd, Madisonville



Show your card. Save money.

As a Hopkins County Farm Bureau member, you have access to discounts and benefits on a wide range of products and services. You can learn more about all our member benefits or how you can become a member by contacting the Hopkins County Farm Bureau office, or by visiting kyfb.com.

585 Nebo Rd., Madisonville
270-452-0226



HOPKINS COUNTY FARM BUREAU



Maurice K Gordon

AMERICAN LEGION POST 6

**856 LEGION DR
MADISONVILLE, KY 42431
270.821.9161**



Express Tax Solutions

TAX CONSULTING SERVICES

Trusted Tax Solutions

Our Service:

- ✓ Tax Audit
- ✓ Individual Tax
- ✓ Corporate Tax
- ✓ Tax Consulting

contact us
TODAY

DAWN WALKER & NAOMI EMERSON
1350 S. MAIN ST
MADISONVILLE, KY 42431
270-245-2405



Carhartt

SUPPORTS THE HOPKINS COUNTY FAIR

———— **We're Hiring - Apply Online** ————
———— **carhartt.com** ————





**Livestock &
Poultry
Equipment
Installation
Sales & Service**



**Whether you're working on new construction
or a simple repair, we've got you covered.
We keep a wide variety of replacement parts
in stock and offer delivery service to to the
surrounding counties!
Give us a call today!**



**99 Factory Outlet Drive
Hanson, Kentucky 42413
270-322-9200**



OLD NATIONAL BANK[®]

Your Home Away From Home!

RELAX. UNWIND.
ENJOY NATURE.

HUGGINS HAVEN
— RV CAMPGROUND —

NOW OPEN!

SIMPLE COMFORTS. LASTING MEMORIES.

- PET FRIENDLY
- FREE WI-FI AT OFFICE
- PICNIC TABLES & FIRE RINGS
- CLOSE TO LOCAL ATTRACTIONS
- FIREWOOD & MERCHANDISE AVAILABLE

VISIT US ONLINE www.hugginshaven.com

Come Stay. Relax. Make Memories.

CALL US TODAY **615-974-8535**

INDEX

| | | | |
|---|-------|--|-------|
| 4-H & FFA | 29-39 | Independence Bank..... | 87 |
| A&B Signs | 94 | Instant Zeal Band..... | 59 |
| Addicted2Change Motorsports..... | 82 | Jarrett Brown - Farm Bureau..... | 67 |
| All American Towing..... | 74 | Karaoke Contest..... | 62 |
| American Legion..... | 94 | Karen Lutz Appraisals..... | 76 |
| Animal Medical Center..... | 76 | Kentucky State Fair..... | 78 |
| Antiques & Collectibles..... | 23 | Kesterson's Antiques..... | 72 |
| Arena Events..... | 49-56 | Knight & Sons..... | 91 |
| Arena Sponsors..... | 48 | KT Auto Sales..... | 74 |
| Arts & Crafts..... | 22 | LG&E and KU..... | 66 |
| Atmos Energy..... | 87 | Little Mister & Miss Pageant..... | 46 |
| Baked Goods..... | 25 | Livestock Schedule..... | 18 |
| Baptist Health Deaconess..... | 100 | Madisonville Auto Parts..... | 72 |
| Bluegrass Pharmacy..... | 67 | Madisonville Community College..... | 79 |
| Blue Collar Boys | 55-56 | Map of Fair Grounds..... | 5 |
| Cabinets By Design..... | 69 | Mark Comley Magic..... | 63 |
| Calhoun's Custom Meats..... | 82 | Max Arnold & Sons..... | 84 |
| Calhoun's Pet Show..... | 19 | McEnaney Family McDonald's..... | 72 |
| Canning..... | 24 | Midway Events..... | 58-67 |
| Carhartt..... | 96 | Midway Sponsors..... | 58 |
| Cash Giveaway..... | 6 | Mid-South Truck and Tractor Pull..... | 49 |
| Catering & Creation..... | 89 | Millay Orthodontics..... | 88 |
| City of Hanson..... | 73 | Miller Roofing Construction..... | 1 |
| City of Madisonville..... | 83 | Miller Spectacular Shows..... | 16 |
| CLAAS..... | 71 | Miss Hopkins Pageant..... | 43 |
| Clayton Q Band..... | 58 | Miss Pre-Teen Hopkins Pageant..... | 44 |
| Clean Green Portables..... | 70 | Miss Teen Hopkins Pageant..... | 45 |
| Coalfield Custom Shirt Company..... | 68 | Mrs Hopkins Pageant..... | 41 |
| County Office..... | 77 | Ms Hopkins Pageant..... | 42 |
| Double-T Cattle Co..... | 56 | Motocross..... | 54 |
| e. Hofmann Plastics..... | 81 | Murphy Construction Group..... | 89 |
| Edward Jones – Tara Edwards..... | 70 | NRMS..... | 68 |
| Express Tax Solutions..... | 95 | Ohio Valley Tractor Pullers..... | 51 |
| Fair Board..... | 3 | Old National Bank..... | 98 |
| Farm Crops..... | 28 | Owensboro Health..... | 101 |
| First United Bank..... | 88 | Pageant Sponsors..... | 40 |
| Fresh Floral..... | 26 | Pageant..... | 41-47 |
| Fruits & Vegetables..... | 27 | Play "N" Hooky Pedal Tractor Pull..... | 65 |
| Glass Pac..... | 97 | Pollard & Sons Excavating..... | 86 |
| Golden Glaze..... | 84 | Power Machinery & Implement..... | 90 |
| Gospel Concert..... | 60 | Rules & Regulations..... | 4 |
| Go Kart Racing..... | 53 | Rural King..... | 76 |
| Hanson Pharmacy..... | 84 | Sarah Beth Brewer & Miles Gee..... | 61 |
| Harris Funeral Home..... | 69 | Schedule of Events..... | 8-12 |
| Helicopter Rides..... | 64 | Scotty's Contracting & Stone..... | 77 |
| Hilary's..... | 79 | Service Radiator..... | 91 |
| Hillside Antique Tractor Pull..... | 52 | Sponsors..... | 13-15 |
| Home & Garden Department..... | 20-28 | Street Legal Truck Pull..... | 50 |
| Hopkins County Conservation District..... | 73 | Talent Show..... | 62 |
| Hopkins County Farm Bureau..... | 93 | Textiles..... | 21 |
| Huggins Haven RV Campground..... | 98 | Toddler Pageant..... | 47 |
| Tourism..... | 17 | Warrior Coal..... | 85 |
| Hot Air Balloons..... | 52 | Young Concrete..... | 92 |
| Index..... | 99 | 5-Star Electric..... | 80 |

BUILDING OUR FUTURE



We're committed to providing quality rural healthcare access in western Kentucky.

Our 3-year, \$120 million dollar renovation and expansion project brings improvements to **Emergency Department, Behavioral Health, Surgery, and Oncology** services, as well as critical infrastructure to support our growing facility.

Thank you for trusting us with your care.



Scan QR code for the latest construction updates, or visit:

BaptistHealthDeaconess.com/Construction

The Sign of Excellent Healthcare



When you see the Owensboro Health logo,
you can be confident you have found high-quality healthcare
that our patients increasingly recommend
to their friends and neighbors.

Owensboro Health is a vibrant health system with three hospitals
and a growing network of primary care providers and specialists
in many locations across Western Kentucky and Southern Indiana.
We exist to provide the excellent care you need for a healthier, happier life
– right here, close to home.



OwensboroHealth.org